



FP0183BK

FITTING INSTRUCTIONS FOR FP0183BK FORK PROTECTORS
NORTON COMMANDO 961 SE- SPORT MKI-MKII '09-



LEFT SIDE

RIGHT SIDE

THIS KIT CONTAINS THE ITEMS PICTURED AND LABELLED BELOW.
DO NOT PROCEED UNTIL YOU ARE SURE ALL PARTS ARE PRESENT.

Please note that the way the kit is packed does not necessarily represent the way of mounting to the bike.

Please note that in cases where kits are packed with a plastic tube separating components on the spindle bar (this tube
THE PARTS SHOWN MAY BE REPRESENTATIVE ONLY (FOR CLARITY OF INSTRUCTIONS ONLY)

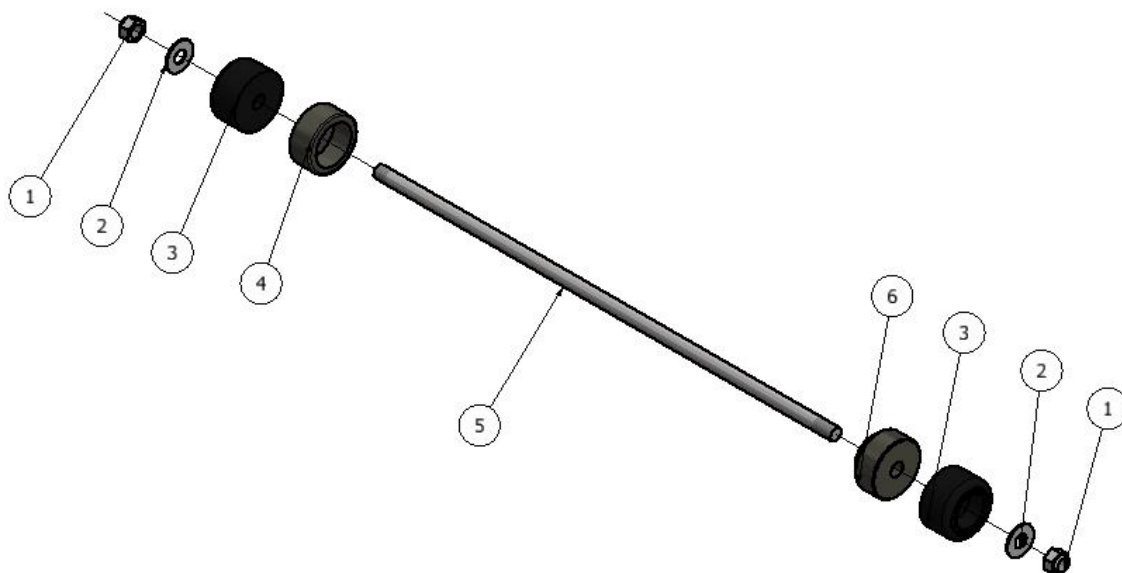

LEFT HAND SIDE

RIGHT HAND SIDE

R&G Racing

Unit 1, Shelley's Lane, East Worldham, Alton, Hampshire, GU34 3AQ

Tel: +44 (0)1420 89007 Fax: +44 (0)1420 87301 www.rg-racing.com Email: info@rg-racing.com



FP0183BK

LEGEND

- ITEM 1 = 2 x M8 nyloc nuts
- ITEM 2 = 2 x M8 washers
- ITEM 3 = 2 x R&G Crash Bobbins (B0510M BK)
- ITEM 4 = 1 x L/H Spacer 15mm long (S0941 BK)
- ITEM 5 = 1 x Spindle bar 325mm long (SB120)
- ITEM 6 = 1 x R/H Spacer 18mm long (S0942 BK)

TOOLS REQUIRED

- Socket set to include 2x 13mm sockets.
- Wrenches

FITTING INSTRUCTIONS

- Starting from the L/H, as you sit on the bike, fit L/H spacer S0941 (Item 4) over the hexagon shaped OEM spindle head on the left hand side of the front spindle.
- Fit one M8 nyloc nut (Item 1) and M8 washer (Item 2) onto the end with shorter thread of the Spindle bar SB120 (Item 5) from the kit. Engage the nut so the nylon insert of the nut is fully engaged.
- Feed the spindle bar (SB120) with nut and washer through either R&G bobbin B0510 (Item 3) and through the spacer just fitted
- Place the remaining spacer (S0942 – Item 6) over the exposed right hand end of spindle bar so the spacer fits inside the round shaped recess on the front spindle. Then slide the remaining R&G bobbin B0510 (Item 3) onto the spindle bar.
- Fit the remaining M8 washer (Item 2) and nyloc nut (Item 1) from the kit onto the thread and tighten until both nuts are engaged in nylon.
- Do not overtighten – the nyloc nuts will hold it tight

ISSUE 1 24/02/2016 (HH)

CONSUMER NOTICE

The catalogue description and any exhibition of samples are only broad indications of the Products and R&G may make design changes which do not diminish their performance or visual appeal and supplying them in such state shall conform to the order. The Buyer acknowledges no representation or warranty (other than as to title) has been given or will apply to the Products other than those in R&G's order or confirmation and the Buyer confirms it has chosen the Products as being of merchantable quality and suitable for its particular purposes. Where R&G fits the Products or undertakes other services it shall exercise reasonable skill and care and rectify any fault free of charge unless the workmanship has been disturbed. The Buyer is responsible for ensuring that the warranty on the motorcycle is not affected by the fitting of the Products. On return of any defective Products R&G shall at its option either supply a replacement or refund the purchase money but shall not be liable if the Products have been modified or used or maintained otherwise than in accordance with R&G's or manufacturer's instructions and good engineering practice or if the defect arises from accident or neglect. Other than identified above and subject to R&G not limiting its liability for causing death and personal injury, it shall not be liable for indirect or consequential loss and otherwise its liability shall be limited to the amounts paid by the Buyer for the Products or the fitting or service concerned. These terms do not affect the Buyer's statutory rights.

R&G RACING RETURNS POLICY (NON-FAULTY GOODS)

Returns must be pre-authorized (if not pre-authorized the return will be rejected). Goods may only be returned direct to us if they were purchased direct from us (customer must prove if necessary). Otherwise to be returned to original vendor. Goods must be in resellable condition, in the opinion of R&G Racing. All returns are subject to a 25% restocking and handling fee (25% of the gross value exc. P&P – at the prevailing price at time of purchase). The customer must pay any and all carriage charges. No returns of discontinued products, unless within 14 days of purchase. This policy does not affect your statutory rights and does not refer to faulty goods.

R&G Racing

Unit 1, Shelley's Lane, East Worldham, Alton, Hampshire, GU34 3AQ

Tel: +44 (0)1420 89007 Fax: +44 (0)1420 87301 www.rg-racing.com Email: info@rg-racing.com



FP0183BK

NOTICE DE MONTAGE FP0183BK PROTECTIONS FOURCHE
NORTON COMMANDO 961 SE- SPORT MKI-MKII '09-



LEFT SIDE

RIGHT SIDE

Le kit contient les articles exposés ci-dessous, vérifier que toutes les pièces soient présentes avant de procéder au montage.

LA FACON DONT LE KIT EST EMBALLE NE CORRESPOND PAS FORCEMENT A LA FACON DE MONTER LES PIECES SUR LA MOTO.

Notez que si les kits sont emballés avec un tube en plastique qui sépare les composants sur l'axe, ce tube doit être jeté).

LES PARTIES PRESENTEES PEUVENT ETRE UNIQUEMENT REPRESENTATIVES (POUR LA CLARTE DES INSTRUCTIONS UNIQUEMENT.

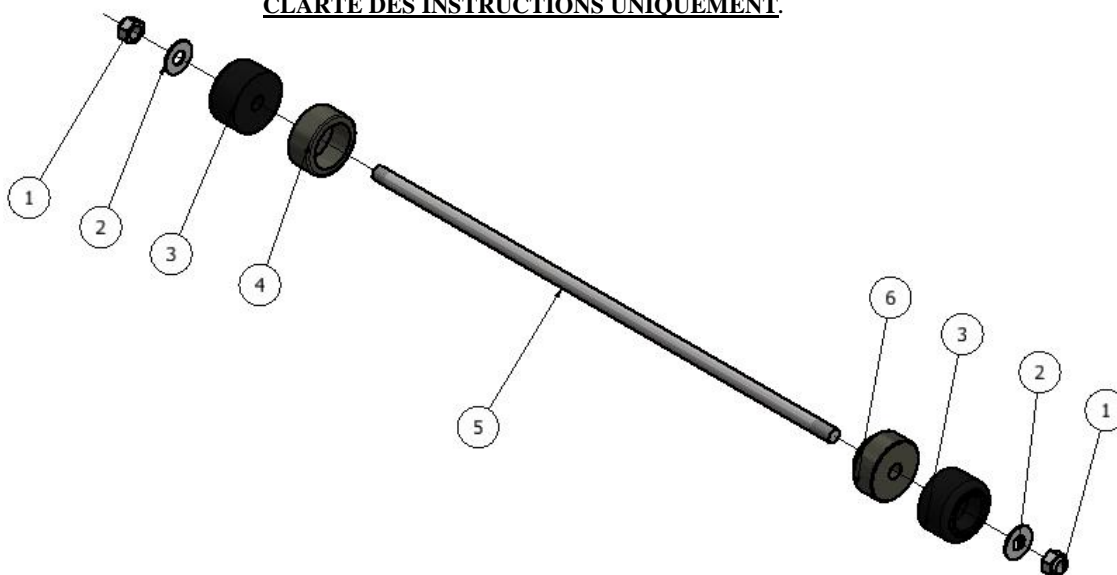

COTE GAUCHE

COTE DROIT



FP0183BK

LEGENDE

- ARTICLE 1 = 2 x M8 Ecrous
- ARTICLE 2 = 2 x M8 Rondelles
- ARTICLE 3 = 2 x R&G Bobines de protection (B0510M BK)
- ARTICLE 4 = 1 x L/H Entretoise 15mm (S0941 BK)
- ARTICLE 5 = 1 x Spindle bar 325mm (SB120)
- ARTICLE 6 = 1 x Entretoise coté droit 18mm (S0942 BK)

OUTILS REQUIS

- Jeu de clés 2x 13mm.
- Clé dynamométrique

NOTICE DE MONTAGE

- En partant du coté gauche, lorsque vous êtes assis sur la moto, insérer l'entretoise coté gauche S0941 (Article 4) sur la tête d'axe d'origine sur coté gauche de l'axe d'origine.
- Insérer un écrou M8 (Article 1) et une rondelle M8 (Article 2) sur l'extrémité au filetage le plus court de l'axe SB120 (Article 5) du kit. Engager l'écrou de façon à ce que l'insert en nylon de l'écrou soit complètement engagé.
- Passer l'axe (SB120) avec écrou et rondelle à travers l'une des bobines R&G B0510 (Article 3) et dans l'entretoise tout juste insérée.
- Placer l'entretoise restante (S0942 – Article 6) sur l'extrémité droite de l'axe de façon à ce que l'entretoise se place dans le creux rond de l'axe avant. Puis, glisser le bobine R&G restante B0510 (Article 3) sur l'axe.
- Insérer la rondelle M8 (Article 2) et l'écrou (Article 1) du kit sur le filetage puis serrer jusqu'à ce que les 2 écrous soient engagés dans le nylon.
- **NE PAS TROP SERRER – Les écrous bloquent suffisamment.**

ISSUE 1 24/02/2016 (HH)

CONSUMER NOTICE

The catalogue description and any exhibition of samples are only broad indications of the Products and R&G may make design changes which do not diminish their performance or visual appeal and supplying them in such state shall conform to the order. The Buyer acknowledges no representation or warranty (other than as to title) has been given or will apply to the Products other than those in R&G's order or confirmation and the Buyer confirms it has chosen the Products as being of merchantable quality and suitable for its particular purposes. Where R&G fits the Products or undertakes other services it shall exercise reasonable skill and care and rectify any fault free of charge unless the workmanship has been disturbed. The Buyer is responsible for ensuring that the warranty on the motorcycle is not affected by the fitting of the Products. On return of any defective Products R&G shall at its option either supply a replacement or refund the purchase money but shall not be liable if the Products have been modified or used or maintained otherwise than in accordance with R&G's or manufacturer's instructions and good engineering practice or if the defect arises from accident or neglect. Other than identified above and subject to R&G not limiting its liability for causing death and personal injury, it shall not be liable for indirect or consequential loss and otherwise its liability shall be limited to the amounts paid by the Buyer for the Products or the fitting or service concerned. These terms do not affect the Buyer's statutory rights.

R&G RACING RETURNS POLICY (NON-FAULTY GOODS)

Returns must be pre-authorized (if not pre-authorized the return will be rejected). Goods may only be returned direct to us if they were purchased direct from us (customer must prove if necessary). Otherwise to be returned to original vendor. Goods must be in resellable condition, in the opinion of R&G Racing. All returns are subject to a 25% restocking and handling fee (25% of the gross value exc. P&P – at the prevailing price at time of purchase). The customer must pay any and all carriage charges. No returns of discontinued products, unless within 14 days of purchase. This policy does not affect your statutory rights and does not refer to faulty goods.

R&G Racing

Unit 1, Shelley's Lane, East Worldham, Alton, Hampshire, GU34 3AQ

Tel: +44 (0)1420 89007 Fax: +44 (0)1420 87301 www.rg-racing.com Email: info@rg-racing.com