



**FITTING INSTRUCTIONS FOR AB0011BK ADVENTURE BARS**  
**KTM 1190 ADVENTURE 2013-**



PICTURE A



PICTURE B

**THIS KIT CONTAINS THE ITEMS PICTURED AND LABELLED BELOW.**  
**DO NOT PROCEED UNTIL YOU ARE SURE ALL PARTS ARE PRESENT.**

Digital copies of these instructions are available to download from [www.rg-racing.com](http://www.rg-racing.com)

Please note that the way the kit is packed does not necessarily represent the way of mounting to the bike

THE PARTS SHOWN MAY BE REPRESENTATIVE ONLY (FOR CLARITY OF INSTRUCTIONS ONLY)

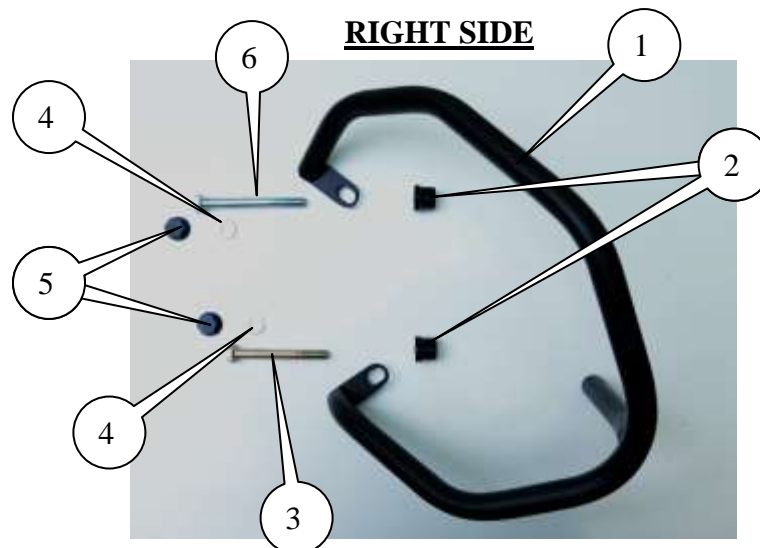

R&G Racing

Unit 1, Shelley's Lane, East Worldham, Alton, Hampshire, GU34 3AQ  
Tel: +44 (0)1420 89007 Fax: +44 (0)1420 87301 [www.rg-racing.com](http://www.rg-racing.com) Email: [info@rg-racing.com](mailto:info@rg-racing.com)



**LEFT SIDE**

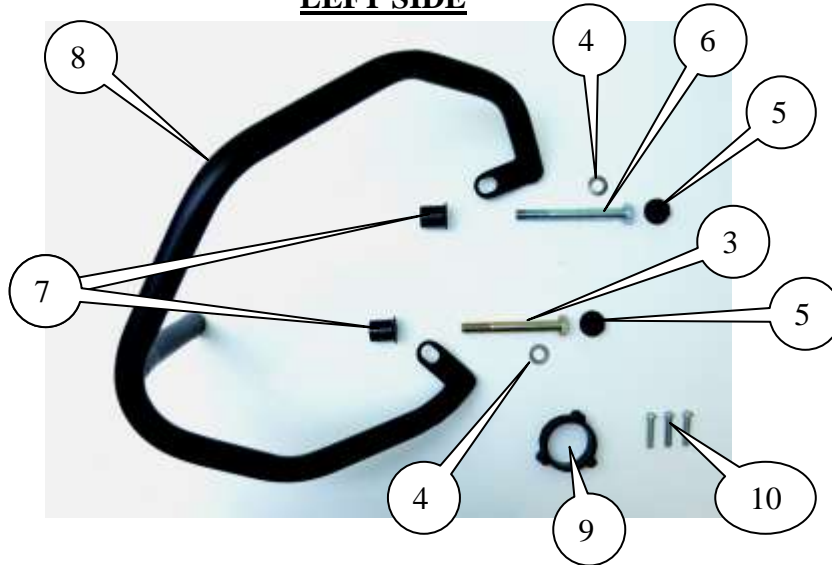

**CENTER**

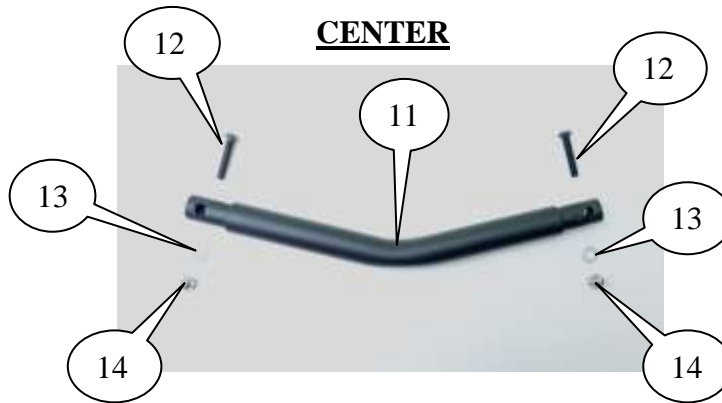

**LEGEND**

- ITEM 1 = ADVENTURE BAR RIGHT-HAND SIDE (CB032) (x1).
- ITEM 2 = SPACERS (S0207 – 20mm LONG) (x2).
- ITEM 3 = M10 x 1.5 x 90mm LONG HEX HEAD BOLTS (x2).
- ITEM 4 = M10 WASHERS (x4).
- ITEM 5 = 17mm HEX HEAD PLASTIC CAPS (x4).
- ITEM 6 = M10 x 1.5 x 100mm LONG HEX HEAD BOLTS (x2).
- ITEM 7 = SPACERS (S0142 – 24mm LONG) (x2).
- ITEM 8 = ADVENTURE BAR LEFT-HAND SIDE (CB031) (x1).
- ITEM 9 = OIL FILLER SPACER (S0734 – 16mm THICK) (x1).
- ITEM 10 = 6 x 30mm LONG COARSE THREADED BOLT (x3).



- ITEM 11 = ADVENTURE BAR SPANNING TUBE (SPT01) (x1).  
ITEM 12 = M6 x 1.25 x 28mm LONG BUTTON HEAD BOLT (x2).  
ITEM 13 = M6 WASHERS (x2).  
ITEM 14 = M6 x 1.25 DOMED NUTS (x2).

### **TOOLS REQUIRED**

- Socket set to include a 10 & 17mm sockets and wrench.
- Allen keys to include 4mm A/F.
- Torx T20 & T45 socket.
- Torque wrench (up to 40Nm).



Picture 1



Picture 2



Picture 3



Picture 4



Picture 5



Picture 6



Picture 7



Picture 8



Picture 9



Picture 10



Picture 11



Picture 12

## **FITTING INSTRUCTIONS**

- Remove the two T45 bolts which secure the plastic side pod to the engine/frame, as shown in picture 1.
- Take the right hand side adventure bar (item 1 – CB032) and assemble as shown in picture 2 and as explained below.
- Locate one M10 washer (item 4) over one M10 x 1.5 x 100mm long hex head bolt (item 6) and position through the top crash bar mount, (*please use the right side picture as reference*). Place one of the shorter spacers (item 2 – S0207 – 20mm long) over the exposed end of the thread, ensuring the larger diameter end sits against the mounting plate of the crash bar.
- Locate one M10 washer (item 4) over one M10 x 1.5 x 90mm long hex head bolt (item 3) and position through the lower crash bar mount. Place the remaining shorter spacer (item 2 – S0207 –



20mm long) over the exposed end of the thread, ensuring the larger diameter end sits against the mounting plate of the crash bar as before.

- This assembly can now be offered up to the right side of the bike as shown in picture 3. Tighten the bolts loosely just to hold the crash bar in place whilst continuing assembly.
- Take the spanning tube (item 11 – SPT01) and slide it into the now fitted right hand side crash bar, as shown in picture 4. *Do not insert any bolts at this stage.*
- On the left side of the bike, remove the three T20 Torx screws that mount the oil filler to the plastic side pod before gently pulling downward and clear, as shown in picture 5.
- Locate the oil filler spacer (item 9 – S0734 – 16mm thick) over the filler cap and align the holes, as shown in picture 6.
- Re-locate into the plastic side pod and fit the three 6 x 30mm long coarse threaded bolts (item 10) before tightening into place, as shown in picture 7.
- Remove the two T45 bolts which secure the plastic side pod to the engine/frame, as shown in picture 8.
- Take the left hand side adventure bar (item 8 – CB031) and assemble the same way as the right side, ensuring the longer bolt fits in the top mount and the shorter bolt fits the lower mount. Use the remaining two spacers (item 7 – S0142 – 24mm long) with the larger diameter sitting against the mounting plates.
- This assembly can now be offered up to the left side of the bike as shown in picture 9. Ensure the front horizontal tube connects into the already fitted spanning tube and both ends of the spanning tube are fully engaged within each crash bar, before tightening the bolts loosely.
- Take the two M6 x 28mm long button head bolts (item 12) and locate through the two holes on the spanning tube, connecting them to the crash bars (*this may require a little bit of movement for the holes to align*) and then fit one M6 washer (item 13) and one M6 domed nut (item 14) to either bolt, as shown in picture 11.
- Ensure the adventure bars are correctly located before tightening all four bolts. There is some adjustment built into the mounts to allow the bars to be setup identically either side. When correctly mounted, tighten the four bolts to 40N/m and ensure the two nuts are fully tightened on the spanning tube.
- Fit the four 17mm hex head plastic caps (item 5) to the four bolt heads to protect them from the elements and give a clean look.

ISSUE 1 21/01/2014 (AR)

#### CONSUMER NOTICE

The catalogue description and any exhibition of samples are only broad indications of the Products and R&G may make design changes which do not diminish their performance or visual appeal and supplying them in such state shall conform to the order. The Buyer acknowledges no representation or warranty (other than as to title) has been given or will apply to the Products other than those in R&G's order or confirmation and the Buyer confirms it has chosen the Products as being of merchantable quality and suitable for its particular purposes. Where R&G fits the Products or undertakes other services it shall exercise reasonable skill and care and rectify any fault free of charge unless the workmanship has been disturbed. The Buyer is responsible for ensuring that the warranty on the motorcycle is not affected by the fitting of the Products. On return of any defective Products R&G shall at its option either supply a replacement or refund the purchase money but shall not be liable if the Products have been modified or used or maintained otherwise than in accordance with R&G's or manufacturer's instructions and good engineering practice or if the defect arises from accident or neglect. Other than identified above and subject to R&G not limiting its liability for causing death and personal injury, it shall not be liable for indirect or consequential loss and otherwise its liability shall be limited to the amounts paid by the Buyer for the Products or the fitting or service concerned. These terms do not affect the Buyer's statutory rights.



**R&G RACING RETURNS POLICY (NON-FAULTY GOODS)**

Returns must be pre-authorized (if not pre-authorized the return will be rejected). Goods may only be returned direct to us if they were purchased direct from us (customer must prove if necessary). Otherwise to be returned to original vendor. Goods must be in re-sellable condition, in the opinion of R&G Racing. All returns are subject to a 25% restocking and handling fee (25% of the gross value exc. P&P – at the prevailing price at time of purchase). The customer must pay any and all carriage charges. No returns of discontinued products, unless within 14 days of purchase. This policy does not affect your statutory rights and does not refer to faulty goods.

R&G Racing

Unit 1, Shelley's Lane, East Worldham, Alton, Hampshire, GU34 3AQ

Tel: +44 (0)1420 89007 Fax: +44 (0)1420 87301 [www.rg-racing.com](http://www.rg-racing.com) Email: [info@rg-racing.com](mailto:info@rg-racing.com)



**INSTRUCTIONS DE MONTAGE POUR AB0011BK BARRES AVENTURE**  
**KTM 1190 ADVENTURE 2013-**



PHOTO A



PHOTO B

LE KIT CONTIENT LES ARTICLES EXPOSES CI-DESSOUS, VERIFIER QUE TOUTES LES PIECES SOIENT PRESENTES AVANT DE PROCEDER AU MONTAGE.

**Ces instructions de montage sont disponibles sur [www.rg-racing.com](http://www.rg-racing.com)**

**LA FAÇON DONT LE KIT EST EMBALLÉ NE CORRESPOND PAS FORCÉMENT À LA FAÇON DE MONTER LES PIÈCES SUR LA MOTO.**

LES PARTIES PRESENTEES PEUVENT ETRE UNIQUEMENT REPRESENTATIVES (POUR LA CLARTE DES INSTRUCTIONS UNIQUEMENT)

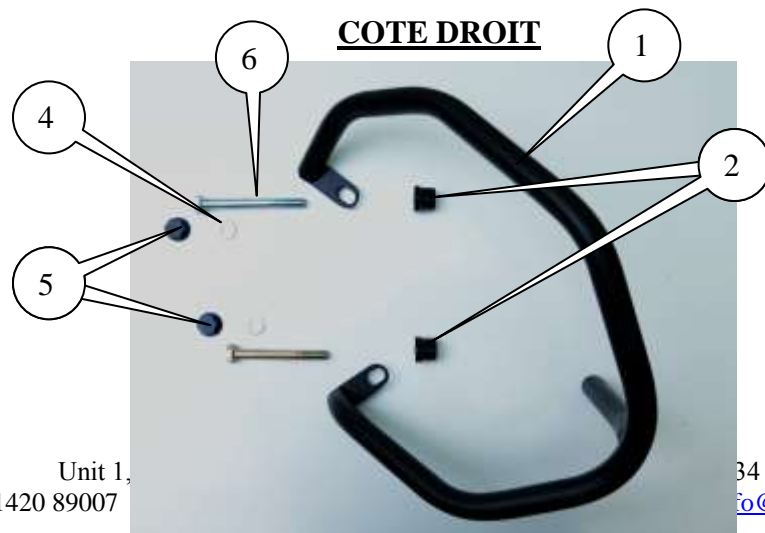



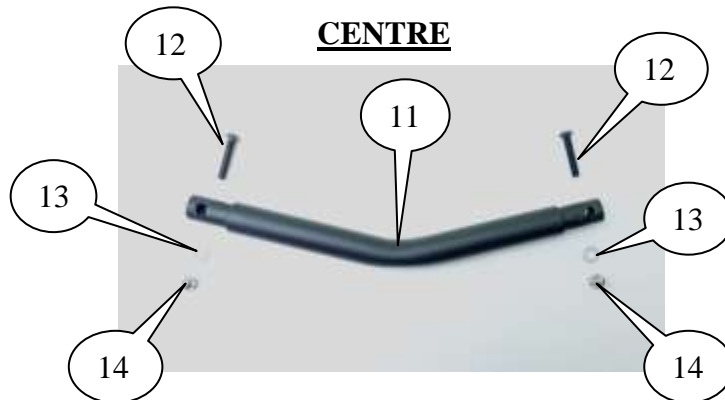
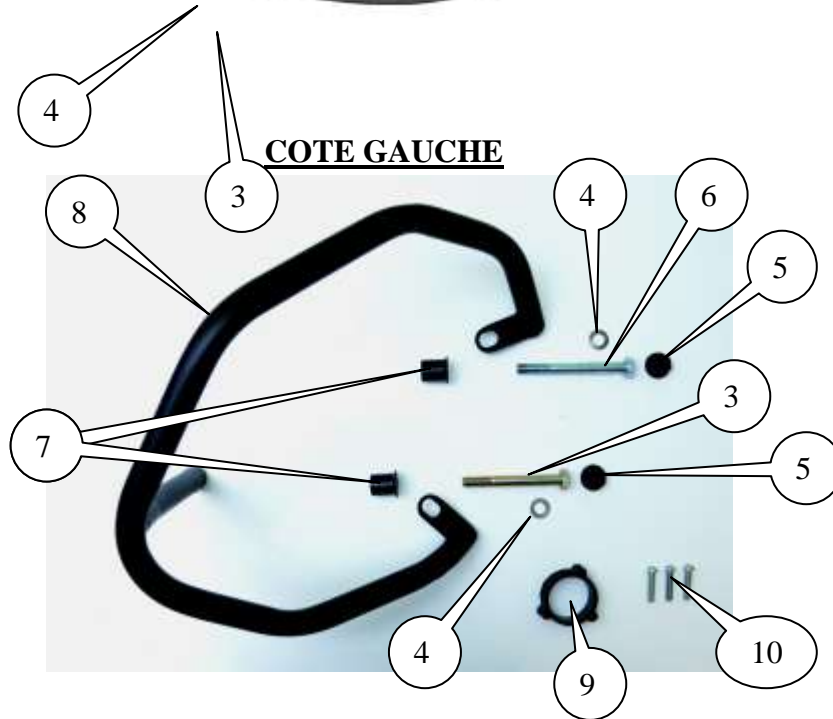

**LEGENDE**

- ARTICLE 1 = BARRE AVENTURE COTE DROIT (CB032) (x1).
- ARTICLE 2 = ENTRETOISES (S0207 – 20mm de long) (x2).
- ARTICLE 3 = M10 x 1.5 x 90mm BOULONS (x2).
- ARTICLE 4 = M10 RONDELLES (x4).
- ARTICLE 5 = 17mm CAPUCHONS POUR TETE HEXAGONALE (x4).
- ARTICLE 6 = M10 x 1.5 x 100mm BOULONS (x2).
- ARTICLE 7 = ENTRETOISES (S0142 – 24mm de long) (x2).



- ARTICLE 8 = BARRE AVENTURE COTE GAUCHE (CB031) (x1).  
ARTICLE 9 = ENTRETOISE REMPLISSAGE D'HUILE (S0734 – 16mm d'épaisseur) (x1).  
ARTICLE 10 = 6 x 30mm BOULON (x3).  
ARTICLE 11 = TUBE BARRE AVENTURE (SPT01) (x1).  
ARTICLE 12 = M6 x 1.25 x 28mm BOULON (x2).  
ARTICLE 13 = M6 RONDELLES (x2).  
ARTICLE 14 = M6 x 1.25 écrous en forme de dôme (x2).

### OUTILS REQUIS

- Jeu de clés à douille 10 & 17mm.
  - Clé Allen 4mm
  - Clé Torx T20 & T45.
- Clé dynamométrique (jusqu'à 40Nm).



Photo 1



Photo 2



Photo 3



Photo 4



Photo 5



Photo 6



Photo 7



Photo 8



Photo 9



Photo 10



Photo 11



Photo 12

### **INSTRUCTIONS DE MONTAGE**

- Enlever les 2 boulons T45 qui fixent la cosse latérale en plastique au moteur/cadre (Photo 1).
- Prendre la Barre Aventure coté droit (Article 1 – CB032) et assemblez comme sur la photo 2 et comme expliqué ci dessous.
- Insérer une rondelle M10 (Article 4) autour d'un boulon M10 x 1.5 x 100mm (Article 6) et positionnez le à travers le support supérieur de protection crash, (*utilisez la photo de droite comme référence*). Placer une des entretoises courtes (Article 2 – S0207 – 20mm de long) autour de l'extrémité du filetage, en vous assurant que le diamètre le plus large se place contre la plaque de montage de la barre de crash.



- Placer une rondelle M10 (Article 4) autour d'un boulon M10 x 1.5 x 90mm (Article 3) et positionnez le à travers le support inférieur de protection crash . Placer l'entretoise courte restante (Article 2 – S0207 – 20mm de long) autour de l'extrémité du filetage, en veillant à ce que le diamètre le plus large se place contre la plaque de montage de la barre de crash comme avant.
- Cet ensemble peut à présent être posé sur la moto du coté droit (Photo 3). Serrer les boulons légèrement, juste pour tenir la barre de crash en place pendant que vous continuez l'assemblage.
- Prendre le tube (Article 11 – SPT01) et glissez le dans la protection crash latérale droite qui est à présent montée (Photo 4). *Ne pas insérer de boulon à ce stade du montage.*
- Du coté gauche de la moto, enlever les 3 vis T20 Torx qui fixent le remplisseur d'huile à la cosse latérale en plastic avant de tirer doucement vers le bas (Photo 5).
- Placer l'entretoise de remplisseur d'huile (Article 9 – S0734 – 16mm d'épaisseur) autour du capuchon de remplissage et aligner les trous (Photo 6).
- Remettre dans la cosse latérale en plastic et placer les 3 boulons 6 x 30mm de long (Article 10) avant de serrer en position (Photo 7).
- Enlever les 2 boulons T45 qui fixent la cosse latérale en plastic au moteur/cadre (Photo 8).
- Prendre la Barre Aventure coté gauche (Article 8 – CB031) et assemblez de la même façon que pour le coté droit, en veillant à ce que le boulon le plus long se place dans le support supérieur et que le boulon le plus court se place dans le support inférieur. Utiliser les 2 entretoises restantes (Article 7 – S0142 – 24mm de long) avec le diamètre le plus large contre les plaques de montage.
- Cet ensemble peut à présent être posé du coté gauche de la moto (Photo 9). Veillez à ce que le tube horizontal avant se connecte correctement avec le tube déjà installé et que les 2 extrémités de ce tube soient complètement engagées dans chaque barre de crash, avant de serrer légèrement les boulons.
- Prendre les 2 boulons M6 x 28mm (Article 12) et placez les à travers les 2 trous dans le tube, les connectant aux barres de crash. *(Cela peut nécessiter un peu de mouvement pour que les trous s'alignent)* Insérez ensuite une rondelle M6 (Article 13) et un écrou en dôme M6 (Article 14) à chaque boulon (Photo 11).
- Veillez à ce que les Barres Aventure soient correctement placées avant de serrer les 4 boulons. Il y a quelques ajustements dans les supports pour permettre aux barres d'être installées de façon identique de chaque coté. Serrer ensuite les 4 boulons à 40N/m et veillez à ce que les 2 écrous soient complètement serrés sur le tube.
- Placez les 4 capuchons 17mm (Article 5) sur les 4 têtes pour les protéger des éléments et donner un aspect plus propre.

ISSUE 1 21/01/2014 (AR)