



FITTING INSTRUCTIONS FOR IA/IAS0031
INDICATOR ADAPTORS



THIS KIT CONTAINS THE ITEMS PICTURED AND LABELLED OVER PAGE.

SOME PARTS MAY BE SHOWN FOR CLARITY OF INSTRUCTIONS ONLY.

DO NOT PROCEED UNTIL YOU ARE SURE ALL PARTS ARE PRESENT.

PLEASE READ ALL INSTRUCTIONS BEFORE PROCEEDING.

**IF IN ANY DOUBT WHEN FITTING OUR PRODUCTS, CONSULT ONE OF
OUR DEALERS OR HAVE FITTED BY A QUALIFIED TECHNICIAN.**

PLEASE NOTE THAT THE WAY THE KIT IS PACKED DOES NOT NECESSARILY REPRESENT THE
WAY OF MOUNTING TO THE BIKE.

IN THE EVENT OF RUBBER WASHERS BEING USED TO HOLD COMPONENTS ONTO BOLTS,
THESE RUBBER WASHERS CAN BE THROWN AWAY.

DIGITAL COPIES OF THESE INSTRUCTIONS ARE AVAILABLE FROM:

WWW.RG-RACING.COM



<u>TOOLS REQUIRED</u>	<u>GENERAL TORQUE SETTINGS</u>
<ul style="list-style-type: none"> • Set of Metric Allen Keys. • Set of Metric spanners or 3/8 socket set and ratchet. • Heat Gun/Lighter 	<p>M4 BOLT = 8Nm</p> <p>M5 BOLT = 12Nm</p> <p>M6 BOLT = 15Nm</p> <p>M8 BOLT = 20Nm</p> <p>M10 BOLT = 40Nm</p> <p>M12 BOLT = 40Nm</p>

LEGEND

ITEM NO.	DESCRIPTION	QTY
1	I0051 - INDICATOR ADAPTOR PLATE	2
2	CON0014 - INDICATOR CONNECTOR	2
3	IWC0001 - INDICATOR WIRING COVER	2
4	666-896/20 - 200mm LENGTH OF HEATSHRINK	2

COMPONENT PARTS DIAGRAM

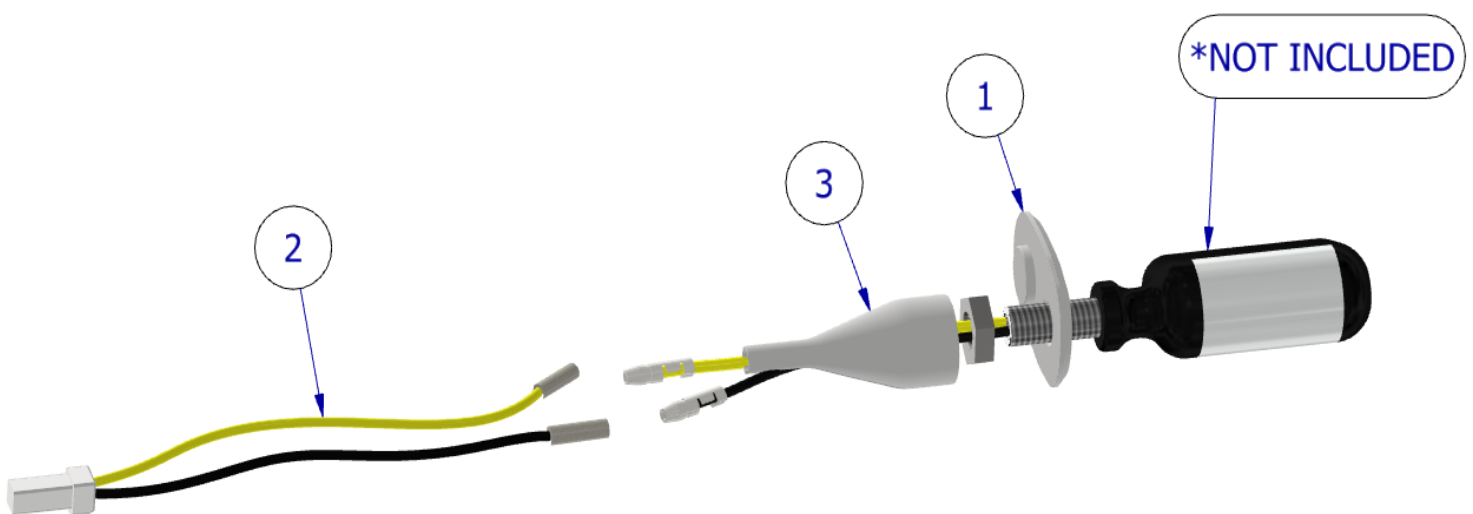



FITTING PICTURES



Picture 1



Picture 2

FITTING INSTRUCTIONS

To install front indicators

- Remove OEM fairings in order to access the rear of the OEM indicators, once accessible, remove and disconnect them ensuring you label them appropriately to aid re-installation.
- Release or cut any cable ties which constrain the OEM indicator wiring.
- To fit R&G mini-indicators (not included) or similar, pre-assemble the components included as shown in **COMPONENT PARTS DIAGRAM** shown above.
- Place one of the indicator adaptor plates (**item 1**) onto the indicator with the chamfered face towards the indicator lens, then place through the mounting face of the bike as shown in **Picture 1**.
- Clamp the indicator into position with the nut, repeat for the remaining indicator on the other side.
- To re-connect the indicators to the original wiring loom, use (**item 2**).
- It is a good idea to check operation at this stage before re-installing the fairings. (*If illumination fails, swap the bullet connections around*). Please note, dependant on the indicators you purchase, you may require resistors to achieve the correct flash rate (these are available separately).
- After testing, disconnect the connectors from both indicators.
- Feed the indicator wiring through one of the nut/wiring covers (**item 3**) as shown in **COMPONENT PARTS DIAGRAM** (it helps if a small amount of liquid detergent is used) and position the nut cover over the nut (repeat the above for the opposite indicator).
- Fit a section of the heat-shrink (**item 4**) over the wires of each indicator so the heat-shrink fits over the stem of the nut/wire cover and gently heat until the heat-shrink contracts to the wiring and nut/wire cover as shown in (repeat the above for the opposite indicator).
- Feed the wiring as original and connect both indicators.
- Refit all the original parts in the reverse order of removal.
- **Please test the indicators before riding.**

R&G

Unit 1, Shelley's Lane, East Worldham, Alton, Hampshire, GU34 3AQ

Tel: +44 (0)1420 89007 Fax: +44 (0)1420 87301 www.rg-racing.com Email: info@rg-racing.com



To install rear indicators

- Remove OEM licence plate assembly in order to remove and disconnect the OEM indicators, ensuring you label the LHS and RHS connectors if necessary to aid re-installation.
- Release or cut any cable ties which constrain the OEM indicator wiring.
- To fit R&G mini-indicators (not included) or similar, pre-assemble the components included as shown in **COMPONENT PARTS DIAGRAM** shown above.
- Place one of the indicator adaptor plates (**item 1**) onto the indicator with the chamfered face towards the indicator lens, then place through the mounting face of the bike as shown in **Picture 2**.
- Clamp the indicator into position with the nut, repeat for the remaining indicator on the other side.
- To re-connect the indicators to the original wiring loom, use (**item 2**).
- It is a good idea to check operation at this stage before re-installing the licence plate assembly. (*If illumination fails, swap the bullet connections around*). Please note, dependant on the indicators you purchase, you may require resistors to achieve the correct flash rate (these are available separately).
- After testing, disconnect the connectors from both indicators.
- Feed the indicator wiring through one of the nut/wiring covers (**item 3**) as shown in **COMPONENT PARTS DIAGRAM** (it helps if a small amount of liquid detergent is used) and position the nut cover over the nut (repeat the above for the opposite indicator).
- Fit a section of the heat-shrink (**item 4**) over the wires of each indicator so the heat-shrink fits over the stem of the nut/wire cover and gently heat until the heat-shrink contracts to the wiring and nut/wire cover as shown in (repeat the above for the opposite indicator).
- Feed the wiring as original and connect both indicators.
- Refit all the original parts in the reverse order of removal.
- **Please test the indicators, rear light, and licence plate illuminator before riding.**

ISSUE 1 11/10/2022 (AO)

CONSUMER NOTICE

The catalogue description and any exhibition of samples are only broad indications of the Products and R&G may make design changes which do not diminish their performance or visual appeal and supplying them in such state shall conform to the order. The Buyer acknowledges no representation or warranty (other than as to title) has been given or will apply to the Products other than those in R&G's order or confirmation and the Buyer confirms it has chosen the Products as being of merchantable quality and suitable for its particular purposes. Where R&G fits the Products or undertakes other services it shall exercise reasonable skill and care and rectify any fault free of charge unless the workmanship has been disturbed. The Buyer is responsible for ensuring that the warranty on the motorcycle is not affected by the fitting of the Products. On return of any defective Products R&G shall at its option either supply a replacement or refund the purchase money but shall not be liable if the Products have been modified or used or maintained otherwise than in accordance with R&G's or manufacturer's instructions and good engineering practice or if the defect arises from accident or neglect. Other than identified above and subject to R&G not limiting its liability for causing death and personal injury, it shall not be liable for indirect or consequential loss and otherwise its liability shall be limited to the amounts paid by the Buyer for the Products or the fitting or service concerned. These terms do not affect the Buyer's statutory rights.

R&G

Unit 1, Shelley's Lane, East Worldham, Alton, Hampshire, GU34 3AQ

Tel: +44 (0)1420 89007 Fax: +44 (0)1420 87301 www.rg-racing.com Email: info@rg-racing.com



R&G RETURNS POLICY (NON-FAULTY GOODS)

Returns must be pre-authorized (if not pre-authorized the return will be rejected). Goods may only be returned direct to us if they were purchased direct from us (customer must prove if necessary). Otherwise to be returned to original vendor. Goods must be in re-sellable condition, in the opinion of R&G. All returns are subject to a 25% restocking and handling fee (25% of the gross value exc. P&P – at the prevailing price at time of purchase). The customer must pay any and all carriage charges. No returns of discontinued products, unless within 14 days of purchase. This policy does not affect your statutory rights and does not refer to faulty goods.

R&G

Unit 1, Shelley's Lane, East Worldham, Alton, Hampshire, GU34 3AQ

Tel: +44 (0)1420 89007 Fax: +44 (0)1420 87301 www.rg-racing.com Email: info@rg-racing.com



NOTICE DE MONTAGE POUR IA/IAS0031
ADAPTATEURS DE CLIGNOTANTS



CE KIT CONTIENT LES ARTICLES ILLUSTRÉS ET ÉTIQUETES SUR LA PAGE.

CERTAINES PARTIES PEUVENT ÊTRE PRÉSENTES UNIQUEMENT POUR LA CLARTE DES INSTRUCTIONS.

NE PAS PROCÉDER AU MONTAGE TANT QUE VOUS N'ÊTES PAS SÛR QUE TOUTES LES PIÈCES SOIENT PRÉSENTES.

VEUILLEZ LIRE TOUTES LES INSTRUCTIONS AVANT DE CONTINUER.

EN CAS DE DOUTE LORS DU MONTAGE DE NOS PRODUITS, CONSULTEZ UN DE NOS REVENDEURS OU FAITES APPEL À UN TECHNICIEN QUALIFIÉ.

VEUILLEZ NOTER QUE LA FAÇON DONT LE KIT EST EMBALLÉ NE REPRÉSENTE PAS NECESSAIREMENT LA MANIÈRE DE LE MONTER SUR LA MOTO.

SI DES RONDELLES EN CAOUTCHOUC SONT UTILISÉES POUR MAINTENIR LES COMPOSANTS SUR LES BOULONS, ELLES PEUVENT ÊTRE JETÉES.

NOTICE DISPONIBLE AU TÉLÉCHARGEMENT SUR :

WWW.RG-RACING.COM

R&G

Unit 1, Shelley's Lane, East Worldham, Alton, Hampshire, GU34 3AQ
Tel: +44 (0)1420 89007 Fax: +44 (0)1420 87301 www.rg-racing.com Email: info@rg-racing.com



OUTILS REQUIS	VALEURS DE SERRAGE
<ul style="list-style-type: none"> • Clés Allen. • Clé à cliquet + douilles 3/8 • Pistolet à chaleur 	<ul style="list-style-type: none"> M4 BOULON = 8Nm M5 BOULON = 12Nm M6 BOULON = 15Nm M8 BOULON = 20Nm M10 BOULON = 40Nm M12 BOULON = 40Nm

LÉGENDE

ARTICLE NO.	DESCRIPTION	QTÉ
1	I0051 - PLAQUE D'ADAPTATEUR DE CLIGNOTANT	2
2	CON0014 - CONNECTEUR DE CLIGNOTANT	2
3	IWC0001 - CACHE FIL CLIGNOTANT	2
4	666-896/20 - 200mm MANCHON THERMO RÉTRACTABLE	2

SCHÉMA DES COMPOSANTS

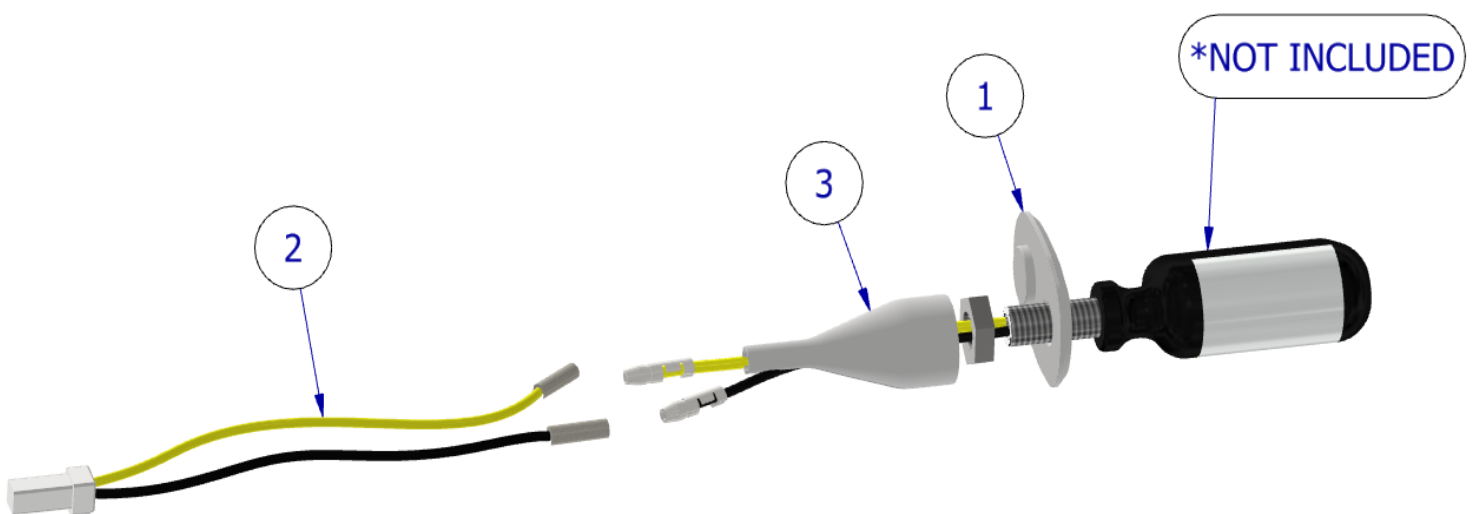



PHOTOS DE MONTAGE



Photo 1



Photo 2

NOTICE DE MONTAGE

Pour installer les clignotants avant

- Retirez les carénages d'origine afin d'accéder à l'arrière des clignotants d'origine, une fois accessibles, retirez-les et déconnectez-les en vous assurant de les étiqueter correctement pour faciliter la réinstallation.
- Desserrez ou coupez les attaches de câble qui retiennent le câblage de clignotant d'origine.
- Pour installer les mini-clignotants R&G (non inclus) ou similaires, pré-assemblez les composants inclus comme indiqué dans le SCHÉMA DES PIÈCES DES COMPOSANTS ci-dessus.
- Placez l'une des plaques d'adaptation de clignotant (article 1) sur le clignotant avec la face chanfreinée vers la lentille du clignotant puis placez-la à travers la face de montage de la moto comme indiqué sur la photo 1.
- Fixez le clignotant en position avec l'écrou, répétez pour le clignotant restant de l'autre côté.
- Pour reconnecter les clignotants au faisceau électrique d'origine, utiliser (article 2).
- Il est judicieux de vérifier le fonctionnement à ce stade avant de réinstaller les carénages. (Si l'éclairage échoue, permutez les connecteurs). Veuillez noter qu'en fonction des clignotants que vous achetez, vous pouvez avoir besoin de résistances pour obtenir le bon niveau d'éclairage (elles sont disponibles séparément).
- Après le test, débranchez les connecteurs des deux clignotants.
- Faites passer le câblage de clignotant à travers l'un des écrous/couvercles de câblage (article 3) comme indiqué dans le SCHÉMA DES PIÈCES DES COMPOSANTS (cela aide si une petite quantité de détergent liquide est utilisée) et placez le couvercle de l'écrou sur l'écrou (répétez ce qui précède pour le clignotant opposé).
- Placez une section de la gaine thermo rétractable (article 4) sur les fils de chaque clignotant de manière à ce que la gaine thermo rétractable s'adapte sur la tige du couvercle de l'écrou/du fil et chauffez doucement jusqu'à ce que

R&G

Unit 1, Shelley's Lane, East Worldham, Alton, Hampshire, GU34 3AQ

Tel: +44 (0)1420 89007 Fax: +44 (0)1420 87301 www.rg-racing.com Email: info@rg-racing.com



la gaine thermo rétractable se contracte sur le câblage et l'écrou/le fil pour le couvrir comme indiqué (répéter ce qui précède pour le clignotant opposé).

- Passer le câblage comme d'origine et connectez les deux clignotants.
- Remonter toutes les pièces d'origine dans l'ordre inverse du démontage.
- Veuillez tester les clignotants avant de rouler.

Pour installer les clignotants arrière

- Retirez le support de plaque d'origine afin de retirer et déconnecter les clignotants d'origine, en veillant à étiqueter les connecteurs gauche et droit si nécessaire pour faciliter la réinstallation.
- Desserrez ou coupez les attaches de câble qui retiennent le câblage de clignotant d'origine.
- Pour installer les mini-clignotants R&G (non inclus) ou similaires, pré-assemblez les composants inclus comme indiqué dans le SCHÉMA DES PIÈCES DES COMPOSANTS ci-dessus
- Placez l'une des plaques d'adaptateur de clignotant (article 1) sur le clignotant avec la face chanfreinée vers la lentille de clignotant, puis placez-la à travers la face de montage de la moto comme indiqué sur la photo 2.
- Fixez le clignotant en position avec l'écrou, répétez pour le clignotant restant de l'autre côté.
- Pour reconnecter les clignotants au faisceau électrique d'origine, utiliser (article 2).
- Il est judicieux de vérifier le fonctionnement à ce stade avant de réinstaller l'ensemble de plaque d'immatriculation. (Si l'éclairage échoue, permutez les connecteurs). Veuillez noter qu'en fonction des clignotants que vous achetez, vous pouvez avoir besoin de résistances pour obtenir le bon niveau d'éclairage (elles sont disponibles séparément)
- Après le test, débranchez les connecteurs des deux clignotants.
- Faites passer le câblage de clignotant à travers l'un des écrous/couvercles de câblage (article 3) comme indiqué dans le SCHÉMA DES PIÈCES DES COMPOSANTS (cela aide si une petite quantité de détergent liquide est utilisée) et placez le couvercle de l'écrou sur l'écrou (répétez ce qui précède pour le clignotant opposé).
- Placez une section de la gaine thermo rétractable (article 4) sur les fils de chaque clignotant de manière à ce que la gaine thermo rétractable s'adapte sur la tige du couvercle de l'écrou/du fil et chauffez doucement jusqu'à ce que la gaine thermo rétractable se contracte sur le câblage et l'écrou/le fil pour le couvrir comme indiqué (répéter ce qui précède pour le clignotant opposé)
- Passer le câblage comme d'origine et connectez les deux clignotants.
- Remonter toutes les pièces d'origine dans l'ordre inverse du démontage.
- Veuillez tester les clignotants avant de rouler.

ISSUE 1 11/10/2022 (AO)

CONSUMER NOTICE

The catalogue description and any exhibition of samples are only broad indications of the Products and R&G may make design changes which do not diminish their performance or visual appeal and supplying them in such state shall conform to the order. The Buyer acknowledges no representation or warranty (other than as to

R&G

Unit 1, Shelley's Lane, East Worldham, Alton, Hampshire, GU34 3AQ

Tel: +44 (0)1420 89007 Fax: +44 (0)1420 87301 www.rg-racing.com Email: info@rg-racing.com



title) has been given or will apply to the Products other than those in R&G's order or confirmation and the Buyer confirms it has chosen the Products as being of merchantable quality and suitable for its particular purposes. Where R&G fits the Products or undertakes other services it shall exercise reasonable skill and care and rectify any fault free of charge unless the workmanship has been disturbed. The Buyer is responsible for ensuring that the warranty on the motorcycle is not affected by the fitting of the Products. On return of any defective Products R&G shall at its option either supply a replacement or refund the purchase money but shall not be liable if the Products have been modified or used or maintained otherwise than in accordance with R&G's or manufacturer's instructions and good engineering practice or if the defect arises from accident or neglect. Other than identified above and subject to R&G not limiting its liability for causing death and personal injury, it shall not be liable for indirect or consequential loss and otherwise its liability shall be limited to the amounts paid by the Buyer for the Products or the fitting or service concerned. These terms do not affect the Buyer's statutory rights.

R&G RETURNS POLICY (NON-FAULTY GOODS)

Returns must be pre-authorized (if not pre-authorized the return will be rejected). Goods may only be returned direct to us if they were purchased direct from us (customer must prove if necessary). Otherwise to be returned to original vendor. Goods must be in re-sellable condition, in the opinion of R&G. All returns are subject to a 25% restocking and handling fee (25% of the gross value exc. P&P – at the prevailing price at time of purchase). The customer must pay any and all carriage charges. No returns of discontinued products, unless within 14 days of purchase. This policy does not affect your statutory rights and does not refer to faulty goods.

R&G

Unit 1, Shelley's Lane, East Worldham, Alton, Hampshire, GU34 3AQ

Tel: +44 (0)1420 89007 Fax: +44 (0)1420 87301 www.rg-racing.com Email: info@rg-racing.com