



**FITTING INSTRUCTIONS FOR FP0264BK FORK PROTECTORS**



**This kit contains the items pictured and labelled over page.  
Some parts may be shown for clarity of instructions only.  
Do not proceed until you are sure all parts are present.  
Please read all instructions before proceeding.**

**IF IN ANY DOUBT WHEN FITTING OUR PRODUCTS, CONSULT ONE OF OUR DEALERS  
OR HAVE FITTED BY A QUALIFIED TECHNICIAN.**

Please note that the way the kit is packed does not necessarily represent the way of mounting to the bike.

In the event of rubber washers being used to hold components onto bolts, these rubber washers can be thrown away.

**DIGITAL COPIES OF THESE INSTRUCTIONS ARE AVAILABLE FROM**

**[WWW.RG-RACING.COM](http://WWW.RG-RACING.COM)**

R&G

Unit 1, Shelley's Lane, East Worldham, Alton, Hampshire, GU34 3AQ  
Tel: +44 (0)1420 89007 Fax: +44 (0)1420 87301 [www.rg-racing.com](http://www.rg-racing.com) Email: [info@rg-racing.com](mailto:info@rg-racing.com)



<b><u>TOOLS REQUIRED</u></b>	<b><u>GENERAL TORQUE SETTINGS</u></b>
<ul style="list-style-type: none"> <li>Socket Set to Include 2 x 13mm sockets and wrenches.</li> </ul>	<p>M4 BOLT = 8Nm                      M5 BOLT = 12Nm                      M6 BOLT = 15Nm                      M8 BOLT = 20Nm                      M10 BOLT = 40Nm                      M12 BOLT = 40Nm</p>

**LEGEND**

<b>ITEM No.</b>	<b>DESCRIPTION</b>
<b>1</b>	M8 NYLOC NUT
<b>2</b>	M8 WASHER 19MM OD
<b>3</b>	M8 CRASH PROTECTOR (B0445M)
<b>4</b>	SPACER LHS (S1407)
<b>5</b>	SPACER RHS (S1408)
<b>6</b>	SPINDLE BAR (S160)

**ASSEMBLY DIAGRAM**

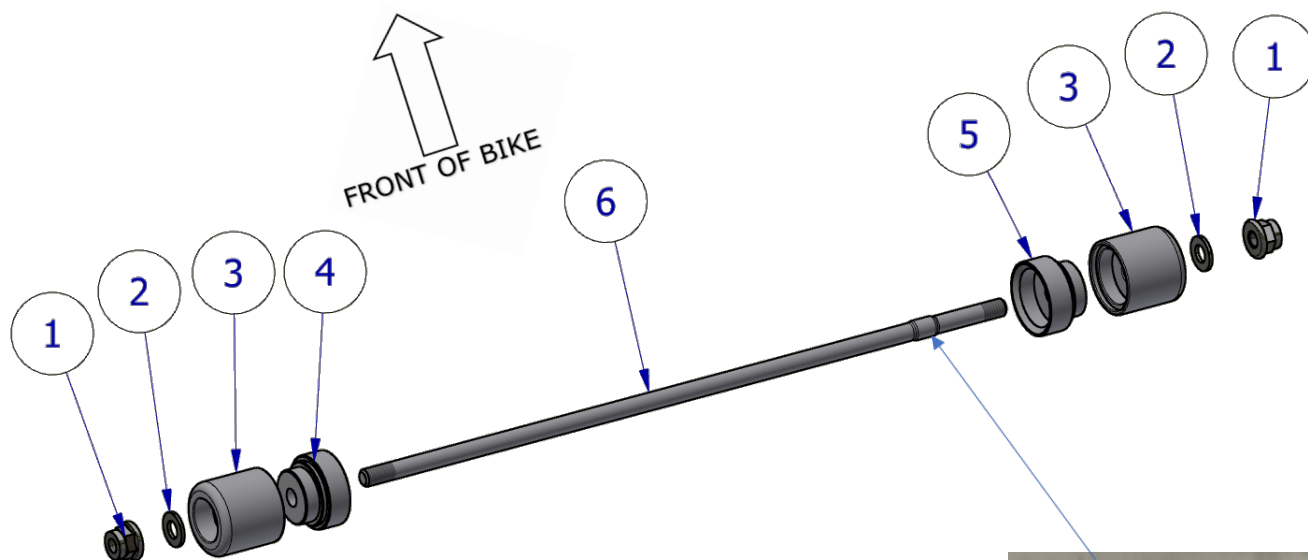

PLEASE NOTE, THE SMALL EXPANDED SECTION OF THE SPINDLE BAR MUST BE POSITIONED ON THE RHS



R&G



## **FITTING INSTRUCTIONS**

- Feed spindle-bar (S160) through the RHS crash protector (B0445M) and through the metal spacer (S1408), as shown in the above picture.
- Fit one nut and washer on the RHS of the spindle-bar (SB160), engage the nut so the plastic insert of nut is fully engaged. It is recommended to use a small amount of Loctite or superglue to fix this nut as this will aid when tightening the opposite side later.
- Place this assembly through the front wheel spindle from the right side, ensuring the small expanded section fits into the spindle.
- Place the remaining spacer (S1407) & crash protector over the exposed end of the spindle bar on the left side of the bike. The crash protector should fit into the fork leg bottom.
- Fit the washer and nut from the kit onto the thread and tighten until both nuts are engaged in nylon and equal amounts protrude from either side (please ensure the logo is located at the top and bottom of the crash protector). Do not overtighten – the nyloc nuts will hold it tight.

ISSUE 1 17/10/2022 (MH)

### **CONSUMER NOTICE**

The catalogue description and any exhibition of samples are only broad indications of the Products and R&G may make design changes which do not diminish their performance or visual appeal and supplying them in such state shall conform to the order. The Buyer acknowledges no representation or warranty (other than as to title) has been given or will apply to the Products other than those in R&G's order or confirmation and the Buyer confirms it has chosen the Products as being of merchantable quality and suitable for its particular purposes. Where R&G fits the Products or undertakes other services it shall exercise reasonable skill and care and rectify any fault free of charge unless the workmanship has been disturbed. The Buyer is responsible for ensuring that the warranty on the motorcycle is not affected by the fitting of the Products. On return of any defective Products R&G shall at its option either supply a replacement or refund the purchase money but shall not be liable if the Products have been modified or used or maintained otherwise than in accordance with R&G's or manufacturer's instructions and good engineering practice or if the defect arises from accident or neglect. Other than identified above and subject to R&G not limiting its liability for causing death and personal injury, it shall not be liable for indirect or consequential loss and otherwise its liability shall be limited to the amounts paid by the Buyer for the Products or the fitting or service concerned. These terms do not affect the Buyer's statutory rights.

### **R&G RACING RETURNS POLICY (NON-FAULTY GOODS)**

Returns must be pre-authorized (if not pre-authorized the return will be rejected). Goods may only be returned direct to us if they were purchased direct from us (customer must prove if necessary). Otherwise to be returned to original vendor. Goods must be in re-sellable condition, in the opinion of R&G Racing. All returns are subject to a 25% restocking and handling fee (25% of the gross value exc. P&P – at the prevailing price at time of purchase). The customer must pay any and all carriage charges. No returns of discontinued products, unless within 14 days of purchase. This policy does not affect your statutory rights and does not refer to faulty goods.

R&G

Unit 1, Shelley's Lane, East Worldham, Alton, Hampshire, GU34 3AQ

Tel: +44 (0)1420 89007 Fax: +44 (0)1420 87301 [www.rg-racing.com](http://www.rg-racing.com) Email: [info@rg-racing.com](mailto:info@rg-racing.com)



**NOTICE DE MONTAGE POUR FP0264BK**  
**PROTECTIONS FOURCHE**



**CE KIT CONTIENT LES ARTICLES ILLUSTRES ET ETIQUETES SUR LA PAGE.**

CERTAINES PARTIES PEUVENT ETRE PRESENTES UNIQUEMENT POUR LA CLARTE DES INSTRUCTIONS.

NE PAS PROCEDER AU MONTAGE TANT QUE VOUS N'ETES PAS SUR QUE TOUTES LES PIECES SOIENT PRESENTES.

**VEUILLEZ LIRE TOUTES LES INSTRUCTIONS AVANT DE CONTINUER.**

**EN CAS DE DOUTE LORS DU MONTAGE DE NOS PRODUITS, CONSULTEZ UN DE NOS REVENDEURS OU FAITES APPEL A UN TECHNICIEN QUALIFIE.**

VEUILLEZ NOTER QUE LA FAÇON DONT LE KIT EST EMBALLE NE REPRESENTE PAS NECESSAIREMENT LA MANIERE DE LE MONTER SUR LA MOTO.

SI DES RONDELLES EN CAOUTCHOUC SONT UTILISEES POUR MAINTENIR LES COMPOSANTS SUR LES BOULONS, ELLES PEUVENT ETRE JETTES.

**NOTICE DISPONIBLE AU TELECHARGEMENT SUR :**

[WWW.RG-RACING.COM](http://WWW.RG-RACING.COM)

R&G

Unit 1, Shelley's Lane, East Worldham, Alton, Hampshire, GU34 3AQ  
Tel: +44 (0)1420 89007 Fax: +44 (0)1420 87301 [www.rg-racing.com](http://www.rg-racing.com) Email: [info@rg-racing.com](mailto:info@rg-racing.com)

**OUTILS REQUIS**

- Clé à cliquet + douilles 2 x 13mm.

**VALEURS DE SERRAGE**

M4 BOULON = 8Nm  
 M5 BOULON = 12Nm  
 M6 BOULON = 15Nm  
 M8 BOULON = 20Nm  
 M10 BOULON = 40Nm  
 M12 BOULON = 40Nm

**LÉGENDE**

ARTICLE No.	DESCRIPTION
1	M8 ÉCROU
2	M8 RONDELLE 19MM
3	M8 PROTECTION CRASH (B0445M)
4	ENTRETOISE CÔTÉ GAUCHE (S1407)
5	ENTRETOISE CÔTÉ DROIT (S1408)
6	AXE (SB161)

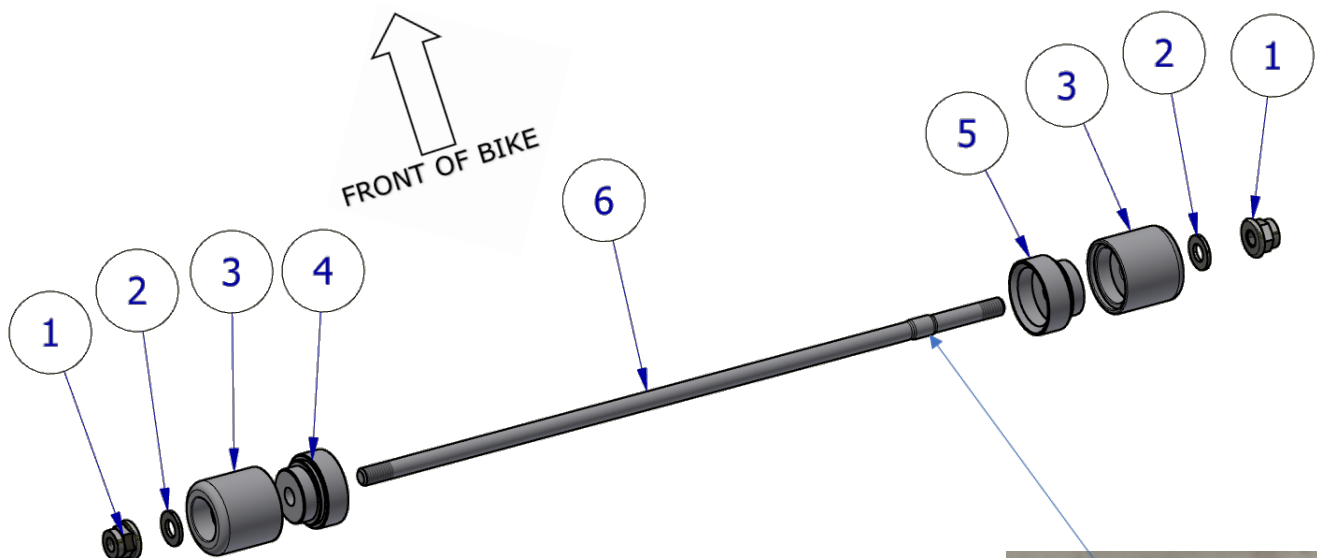
**SCHÉMA DE MONTAGE**

VEUILLEZ NOTER QUE LE PETIT ÉLARGISSEMENT LA SECTION DE LA BARRE DE BROCHE DOIT SE POSITIONNER DU CÔTÉ DROIT



R&amp;G

Unit 1, Shelley's Lane, East Worldham, Alton, Hampshire, GU34 3AQ  
 Tel: +44 (0)1420 89007 Fax: +44 (0)1420 87301 [www.rg-racing.com](http://www.rg-racing.com) Email: [info@rg-racing.com](mailto:info@rg-racing.com)



## **NOTICE DE MONTAGE**

- Faites passer la barre (SB161) à travers la protection crash côté droit (B0445M) et à travers l'entretoise métallique (S1408), comme indiqué sur l'image ci-dessus.
- Montez un écrou et une rondelle sur le côté droit de la barre (SB161), engagez l'écrou de manière à ce que l'insert en plastique de l'écrou soit complètement engagé. Il est recommandé d'utiliser une petite quantité de Loctite ou de superglue pour fixer cet écrou car cela facilitera le serrage ultérieur du côté opposé.
- Placez cet ensemble à travers l'axe de la roue avant à partir du côté droit, en vous assurant que la petite section élargie s'insère dans l'axe.
- Placez l'entretoise restante (S1407) et la protection crash sur l'extrémité exposée de la barre du côté gauche de la moto. La protection crash doit s'insérer dans le bas du bras de fourche.
- Montez la rondelle et l'écrou du kit sur le filetage et serrez jusqu'à ce que les deux écrous soient engagés dans le nylon et que des quantités égales dépassent de chaque côté (veuillez-vous assurer que le logo soit situé en haut et en bas de la protection crash). Ne serrez pas trop - les écrous nyloc fixent l'ensemble.

ISSUE 1 17/10/2022 (MH)

### **CONSUMER NOTICE**

The catalogue description and any exhibition of samples are only broad indications of the Products and R&G may make design changes which do not diminish their performance or visual appeal and supplying them in such state shall conform to the order. The Buyer acknowledges no representation or warranty (other than as to title) has been given or will apply to the Products other than those in R&G's order or confirmation and the Buyer confirms it has chosen the Products as being of merchantable quality and suitable for its particular purposes. Where R&G fits the Products or undertakes other services it shall exercise reasonable skill and care and rectify any fault free of charge unless the workmanship has been disturbed. The Buyer is responsible for ensuring that the warranty on the motorcycle is not affected by the fitting of the Products. On return of any defective Products R&G shall at its option either supply a replacement or refund the purchase money but shall not be liable if the Products have been modified or used or maintained otherwise than in accordance with R&G's or manufacturer's instructions and good engineering practice or if the defect arises from accident or neglect. Other than identified above and subject to R&G not limiting its liability for causing death and personal injury, it shall not be liable for indirect or consequential loss and otherwise its liability shall be limited to the amounts paid by the Buyer for the Products or the fitting or service concerned. These terms do not affect the Buyer's statutory rights.

### **R&G RACING RETURNS POLICY (NON-FAULTY GOODS)**

Returns must be pre-authorized (if not pre-authorized the return will be rejected). Goods may only be returned direct to us if they were purchased direct from us (customer must prove if necessary). Otherwise to be returned to original vendor. Goods must be in re-sellable condition, in the opinion of R&G Racing. All returns are subject to a 25% restocking and handling fee (25% of the gross value exc. P&P – at the prevailing price at time of purchase). The customer must pay any and all carriage charges. No returns of discontinued products, unless within 14 days of purchase. This policy does not affect your statutory rights and does not refer to faulty goods.

R&G

Unit 1, Shelley's Lane, East Worldham, Alton, Hampshire, GU34 3AQ

Tel: +44 (0)1420 89007 Fax: +44 (0)1420 87301 [www.rg-racing.com](http://www.rg-racing.com) Email: [info@rg-racing.com](mailto:info@rg-racing.com)