



FITTING INSTRUCTIONS FOR FE0320 LICENCE PLATE BRACKET



**This kit contains the items pictured and labelled over page.
Some parts may be shown for clarity of instructions only.
Do not proceed until you are sure all parts are present.
Please read all instructions before proceeding.**

**IF IN ANY DOUBT WHEN FITTING OUR PRODUCTS, CONSULT ONE OF OUR DEALERS
OR HAVE FITTED BY A QUALIFIED TECHNICIAN.**

Please note that the way the kit is packed does not necessarily represent the way of mounting to the bike.

In the event of rubber washers being used to hold components onto bolts, these rubber washers can be thrown away.

DIGITAL COPIES OF THESE INSTRUCTIONS ARE AVAILABLE FROM

WWW.RG-RACING.COM

R&G

Unit 1, Shelley's Lane, East Worldham, Alton, Hampshire, GU34 3AQ
Tel: +44 (0)1420 89007 Fax: +44 (0)1420 87301 www.rg-racing.com Email: info@rg-racing.com



<u>TOOLS REQUIRED</u>	<u>GENERAL TORQUE SETTINGS</u>
<ul style="list-style-type: none"> • Set of Torx keys or bits including T20, T25, T30. • Set of metric Allen keys to include 3, 4, 5 & 6mm <ul style="list-style-type: none"> • 6 & 8mm spanner or socket. • Phillips screwdriver. • Small flat head screwdriver. 	M4 BOLT = 8Nm M5 BOLT = 12Nm M6 BOLT = 15Nm M8 BOLT = 20Nm M10 BOLT = 40Nm M12 BOLT = 40Nm

LEGEND

ITEM No.	DESCRIPTION	QTY
ITEM 1	FEP0320BK PART 3 - LICENCE PLATE BRACKET	1
ITEM 2	LA0002 - NUMBER PLATE LIGHT ASSEMBLY	1
ITEM 3	FEP0320BK PART 1 - MAIN BRACKET RHS	1
ITEM 4	FEP0320BK PART 2 - MAIN BRACKET LHS	1
ITEM 5	S1360 - MOUNTING SPACERS	4
ITEM 6	150mm LENGTH OF HEATSHRINK	1
ITEM 7	M5x0.8x10.0 mm COUNTER SUNK SCREWS	4
ITEM 8	M5x10mm WASHERS	4
ITEM 9	M5x0.8 NYLOC NUTS	4
ITEM 10	M6x1.0x15mm BUTTON HEAD SCREWS	2
ITEM 11	M6 X 12MM WASHER	2
ITEM 12	M6x19mm WASHER	4
ITEM 13	CON0065 - LICENCE PLATE ILLUMINATOR CONNECTOR	1
ITEM 14	M6 NYLOC NUTS	2
ITEM 15	2.5mm CABLE TIES	4
ITEM 16	CLIP 1 - SELF ADHEISIVE CABLE CLIPS	2
ITEM 17	REFL 3 - REFLECTOR	1

R&G

Unit 1, Shelley's Lane, East Worldham, Alton, Hampshire, GU34 3AQ

Tel: +44 (0)1420 89007 Fax: +44 (0)1420 87301 www.rg-racing.com Email: info@rg-racing.com



ASSEMBLY DIAGRAM

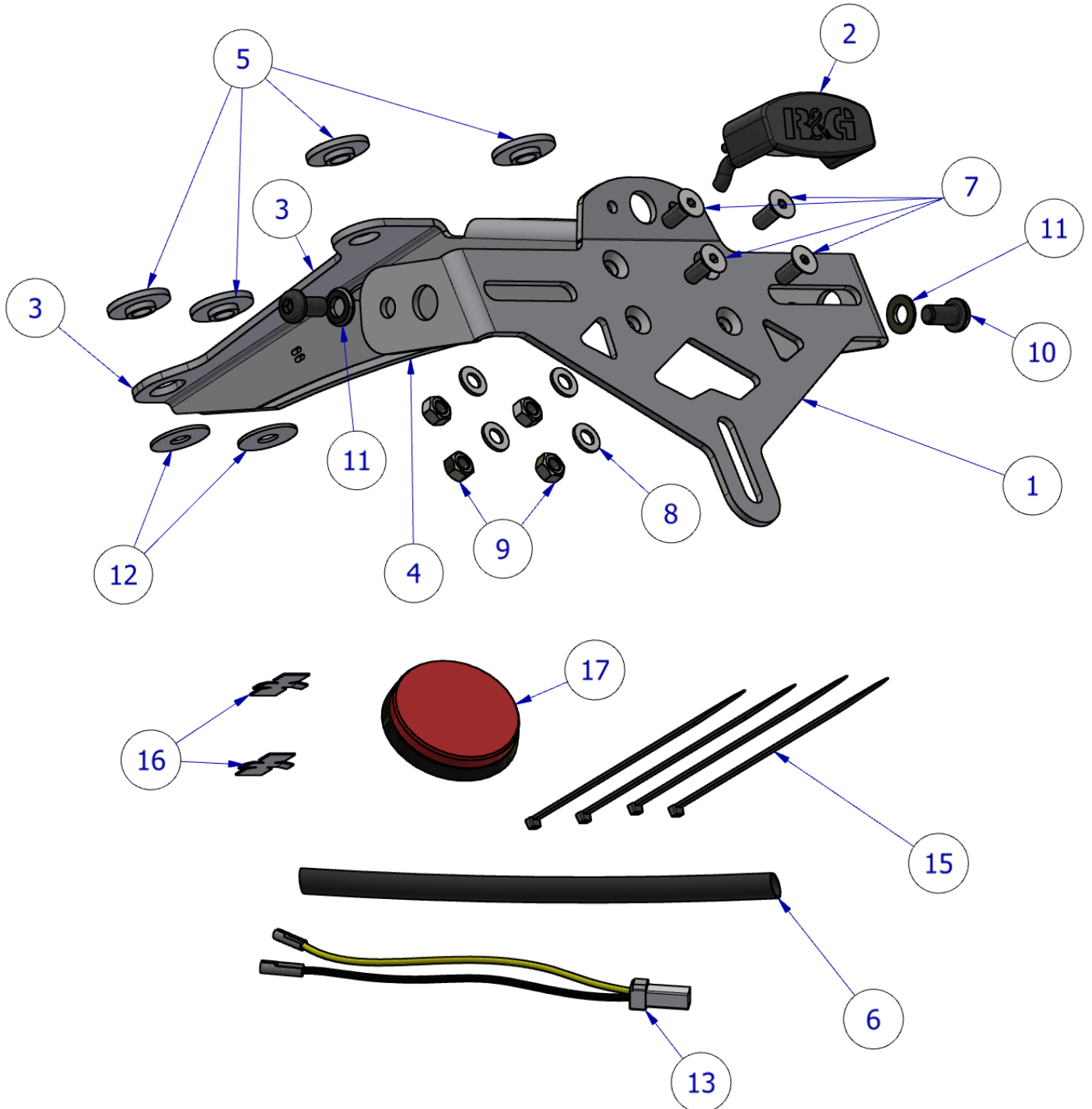

R&G

Unit 1, Shelley's Lane, East Worldham, Alton, Hampshire, GU34 3AQ

Tel: +44 (0)1420 89007 Fax: +44 (0)1420 87301 www.rg-racing.com Email: info@rg-racing.com



FITTING PICTURES



Picture 1



Picture 2



Picture 3



Picture 4

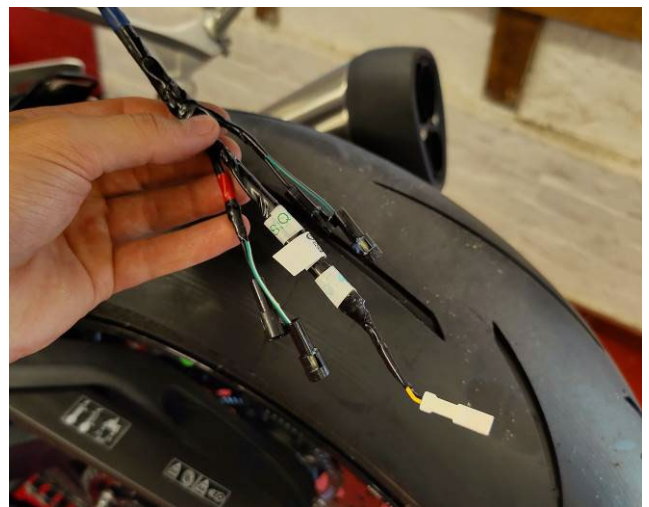



Picture 5

Picture 6



Picture 7

Picture 8

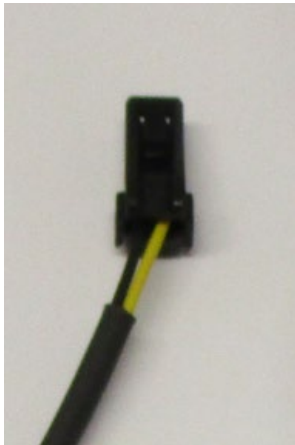

Picture 9

Picture 10



Picture 11



FITTING INSTRUCTIONS

- Begin by unscrewing the bolts securing the OEM licence plate holder to the tail unit of the bike with a T20 Torx driver as shown in **Picture 1**.
- This will leave the licence plate holder loose and connected only by the indicator wires, keep the licence plate holder supported so that the wires are not damaged as shown in **picture 2**.
- Gently pull the plastic cover piece to remove it as shown in **Picture 3**.
- This will expose the 2 screws shown in **Picture 4**. These must be removed using a T20 Torx drive to separate the 2 halves of the licence plate holder.
- The remaining plastic covers can now be carefully removed.
- With the indicator and illuminator connectors exposed as shown in **Picture 5**, disconnect these, and remove the OEM licence plate holder, leaving the wires shown in **Picture 6**. (Take note of which indicators are connected to the left and right sides as these will need to be reconnected correctly when re-connecting the R&G tail tidy.)
- To fit the OEM indicators, remove the bolts holding these to the licence plate holder and unthread the wires to free them. Ensuring these are installed on the correct sides, these can then be secured to the R&G Tail Tidy using the M6 screws and Nyloc nuts provided (**items 10 & 11**).
- Assemble the R&G tail tidy as shown in **Picture 7** and the **Assembly Diagram** by using the M5 countersunk screws, M5 washers and M5 Nyloc nuts fasteners provided. ensure the nuts are tight.
- Attach the R&G licence plate illuminator (**Item 2**) as shown in **Picture 8**.
- Use the heat shrink provided (**item 6**) to seal the licence plate illuminator wires.
- Insert the 4 spacers (**Item 5**) into the mounting holes as shown in **Assembly diagram** ensuring that the flat sides face upwards.
- Connect CON0065 Licence plate illuminator connector (**Item 13**) as shown on **Picture 9**, to the illuminator wires ensuring to connect black to black.
- Reconnect the indicator and illuminator connectors to the wires protruding from the tail unit of the motorcycle. Ensure that the left and right indicators are connected correctly. (This can be checked by turning on the ignition and testing that they flash correctly.)
- Attach the R&G tail tidy to the tail unit of the motorcycle using the same 4 Torx screws which were removed from the OEM licence plate holder as well as the large M6 washers (**item 12**) provided as shown in **Picture 10**.
- The wires can be tidied up using the cable ties and cable tie slots in the tail tidy as shown in **Picture 11**.

IMPORTANT: FOR SAFETY, ENSURE THE LICENCE PLATE IS PLACED AS HIGH AS POSSIBLE ON THE TAIL TIDY (IT MAY REQUIRE DRILLING). IF FITTING A LICENCE PLATE OF 200MM OR LONGER (INCLUDING ANY SHROUD OR REFLECTOR ATTACHMENT) TO THE BRACKET, BEFORE RIDING, FULLY COMPRESS THE SUSPENSION TO ENSURE NO PART OF THE ASSEMBLY CAN CONTACT THE TYRE WHILE THE VEHICLE IS IN MOTION OR UNDER LOAD. IT IS YOUR RESPONSIBILITY TO CHECK FOR THIS POSSIBILITY AND TAKE AVOIDING ACTION. FAILURE TO CHECK THIS COULD RESULT IN SERIOUS INJURY OR DAMAGE TO THE MOTORCYCLE.

ISSUE 1 - 31/08/2022 - (DM)

R&G

Unit 1, Shelley's Lane, East Worldham, Alton, Hampshire, GU34 3AQ

Tel: +44 (0)1420 89007 Fax: +44 (0)1420 87301 www.rg-racing.com Email: info@rg-racing.com



CONSUMER NOTICE

The catalogue description and any exhibition of samples are only broad indications of the Products and R&G may make design changes which do not diminish their performance or visual appeal and supplying them in such state shall conform to the order. The Buyer acknowledges no representation or warranty (other than as to title) has been given or will apply to the Products other than those in R&G's order or confirmation and the Buyer confirms it has chosen the Products as being of merchantable quality and suitable for its particular purposes. Where R&G fits the Products or undertakes other services it shall exercise reasonable skill and care and rectify any fault free of charge unless the workmanship has been disturbed. The Buyer is responsible for ensuring that the warranty on the motorcycle is not affected by the fitting of the Products. On return of any defective Products R&G shall at its option either supply a replacement or refund the purchase money but shall not be liable if the Products have been modified or used or maintained otherwise than in accordance with R&G's or manufacturer's instructions and good engineering practice or if the defect arises from accident or neglect. Other than identified above and subject to R&G not limiting its liability for causing death and personal injury, it shall not be liable for indirect or consequential loss and otherwise its liability shall be limited to the amounts paid by the Buyer for the Products or the fitting or service concerned. These terms do not affect the Buyer's statutory rights.

R&G RACING RETURNS POLICY (NON-FAULTY GOODS)

Returns must be pre-authorized (if not pre-authorized the return will be rejected). Goods may only be returned direct to us if they were purchased direct from us (customer must prove if necessary). Otherwise to be returned to original vendor. Goods must be in re-sellable condition, in the opinion of R&G Racing. All returns are subject to a 25% restocking and handling fee (25% of the gross value exc. P&P – at the prevailing price at time of purchase). The customer must pay any and all carriage charges. No returns of discontinued products, unless within 14 days of purchase. This policy does not affect your statutory rights and does not refer to faulty goods.

R&G

Unit 1, Shelley's Lane, East Worldham, Alton, Hampshire, GU34 3AQ

Tel: +44 (0)1420 89007 Fax: +44 (0)1420 87301 www.rg-racing.com Email: info@rg-racing.com



NOTICE DE MONTAGE POUR FE0320 SUPPORT DE PLAQUE



CE KIT CONTIENT LES ARTICLES ILLUSTRÉS ET ÉTIQUETES SUR LA PAGE.

CERTAINES PARTIES PEUVENT ÊTRE PRÉSENTES UNIQUEMENT POUR LA CLARTÉ DES INSTRUCTIONS.

NE PAS PROCÉDER AU MONTAGE TANT QUE VOUS N'ÊTES PAS SÛR QUE TOUTES LES PIÈCES SOIENT PRÉSENTES.

VEUILLEZ LIRE TOUTES LES INSTRUCTIONS AVANT DE CONTINUER.

EN CAS DE DOUTE LORS DU MONTAGE DE NOS PRODUITS, CONSULTEZ UN DE NOS REVENDEURS OU FAITES APPEL À UN TECHNICIEN QUALIFIÉ.

VEUILLEZ NOTER QUE LA FAÇON DONT LE KIT EST EMBALLÉ NE REPRÉSENTE PAS NECESSAIREMENT LA MANIÈRE DE LE MONTER SUR LA MOTO.

SI DES RONDELLES EN CAOUTCHOUC SONT UTILISÉES POUR MAINTENIR LES COMPOSANTS SUR LES BOULONS, ELLES PEUVENT ÊTRE JETÉES.

NOTICE DISPONIBLE AU TÉLÉCHARGEMENT SUR :

WWW.RG-RACING.COM

R&G

Unit 1, Shelley's Lane, East Worldham, Alton, Hampshire, GU34 3AQ

Tel: +44 (0)1420 89007 Fax: +44 (0)1420 87301 www.rg-racing.com Email: info@rg-racing.com



<u>OUTILS REQUIS</u>	<u>VALEURS DE SERRAGE</u>
<ul style="list-style-type: none"> • Clés Torx T20, T25, T30. • Clés Allen 3, 4, 5 & 6mm • Clé à cliquet + douilles 6 & 8mm. <ul style="list-style-type: none"> • Tournevis cruciforme. • Petit tournevis plat. 	M4 BOULON = 8Nm M5 BOULON = 12Nm M6 BOULON = 15Nm M8 BOULON = 20Nm M10 BOULON = 40Nm M12 BOULON = 40Nm

LÉGENDE

ARTICLE No.	DESCRIPTION	QTÉ
ARTICLE 1	FEP0320BK PART 3 – SUPPORT DE PLAQUE	1
ARTICLE 2	LA0002 – ASSEMBLAGE FEU DE PLAQUE	1
ARTICLE 3	FEP0320BK PART 1 – SUPPORT PRINCIPAL CÔTÉ DROIT	1
ARTICLE 4	FEP0320BK PART 2 – SUPPORT PRINCIPAL CÔTÉ GAUCHE	1
ARTICLE 5	S1360 – ENTRETOISES DE FIXATION	4
ARTICLE 6	150mm MANCHON THERMO RÉTRACTABLE	1
ARTICLE 7	M5x0.8x10.0 mm VIS	4
ARTICLE 8	M5x10mm RONDELLES	4
ARTICLE 9	M5x0.8 ÉCROUS	4
ARTICLE 10	M6x1.0x15mm VIS	2
ARTICLE 11	M6 X 12MM RONDELLE	2
ARTICLE 12	M6x19mm RONDELLE	4
ARTICLE 13	CON0065 – CONNECTEUR DE FEU DE PLAQUE	1
ARTICLE 14	M6 ÉCROUS	2
ARTICLE 15	2.5mm COLLIERS DE SERRAGE	4
ARTICLE 16	CLIP 1 – CLIPS AUTOCOLLANT	2
ARTICLE 17	REFL 3 - RÉFLECTEUR	1

R&G

Unit 1, Shelley's Lane, East Worldham, Alton, Hampshire, GU34 3AQ

Tel: +44 (0)1420 89007 Fax: +44 (0)1420 87301 www.rg-racing.com Email: info@rg-racing.com



SCHÉMA D'ENSEMBLE

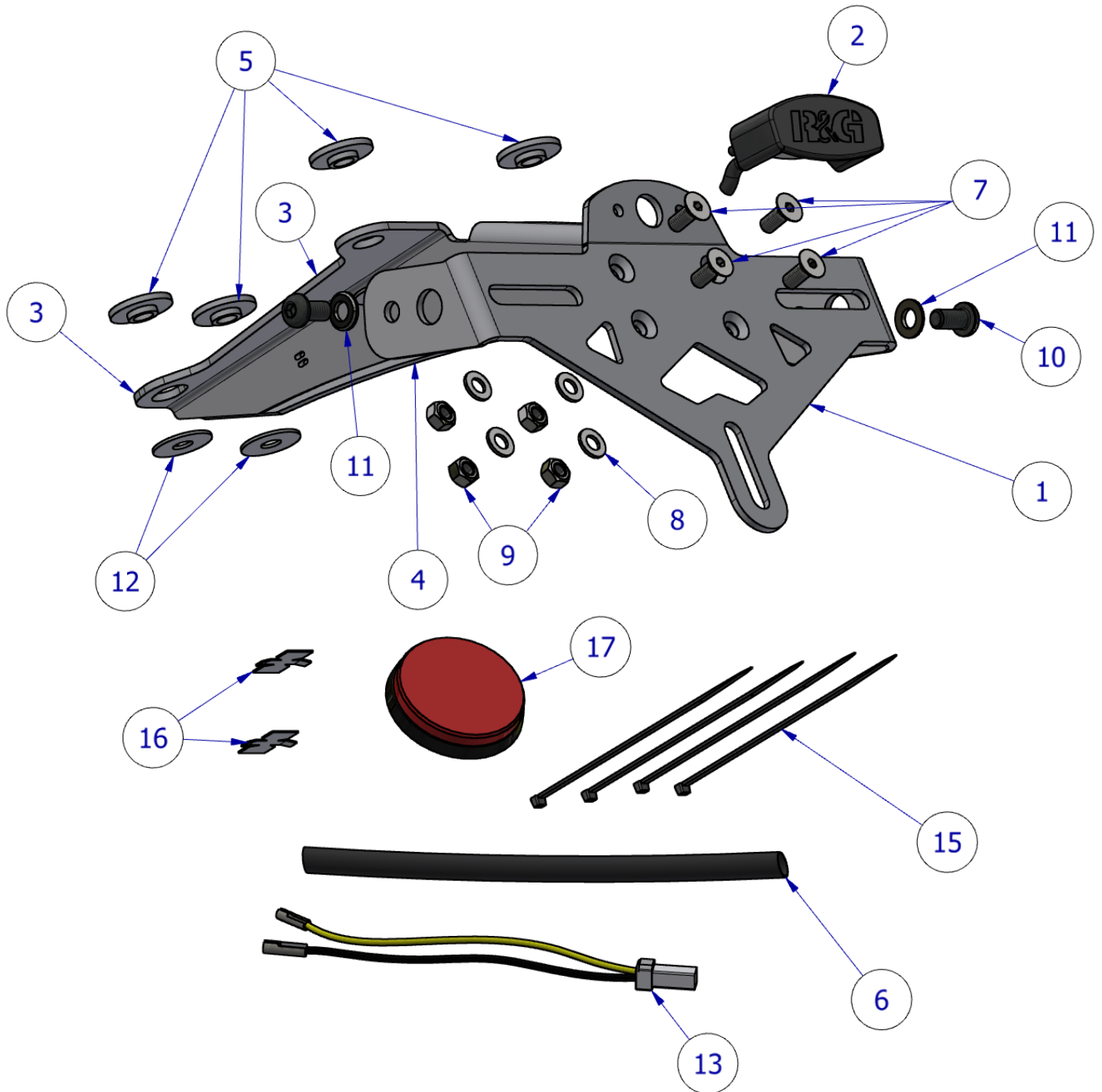

R&G

Unit 1, Shelley's Lane, East Worldham, Alton, Hampshire, GU34 3AQ

Tel: +44 (0)1420 89007 Fax: +44 (0)1420 87301 www.rg-racing.com Email: info@rg-racing.com



PHOTOS DE MONTAGE



Photo 1



Photo 2



Photo 3



Photo 4

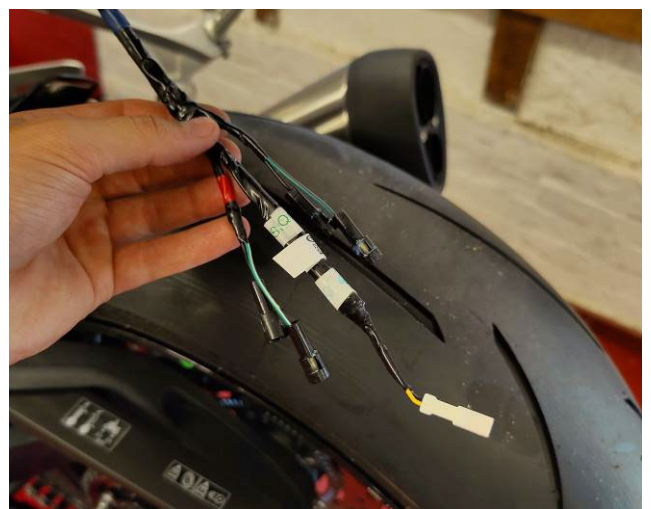



Photo 5

Photo 6



Photo 7

Photo 8

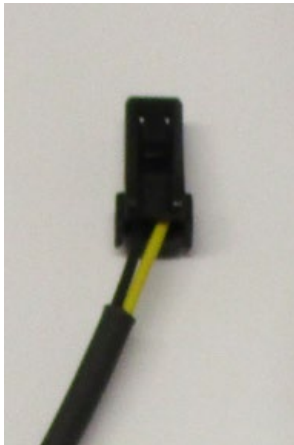

Photo 9

Photo 10

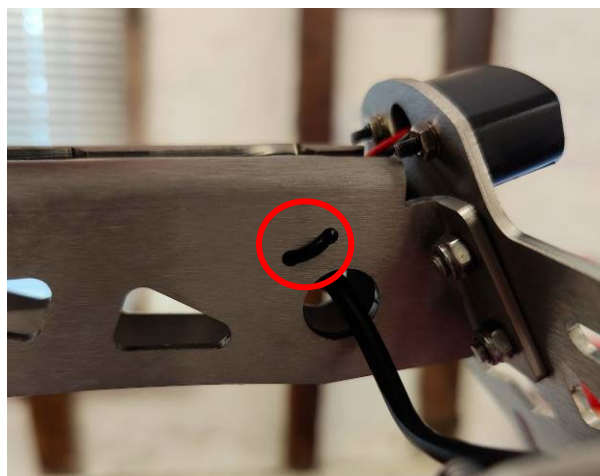

Photo 11



NOTICE DE MONTAGE

- Commencez par dévisser les boulons fixant le support de plaque d'immatriculation d'origine à l'unité arrière de la moto avec un tournevis Torx T20 comme indiqué sur la photo 1.
- Cela laissera le support de plaque d'immatriculation desserré et connecté uniquement par les fils de clignotant, maintenez le support de plaque d'immatriculation soutenu afin que les fils ne soient pas endommagés, comme indiqué sur la photo 2.
- Tirez doucement sur le couvercle en plastique pour le retirer comme indiqué sur la Photo 3.
- Cela exposera les 2 vis illustrées sur la photo 4. Celles-ci doivent être retirées à l'aide d'un tournevis Torx T20 pour séparer les 2 moitiés du support de plaque d'immatriculation.
- Les couvercles en plastique restants peuvent maintenant être retirés avec précaution.
- Avec les connecteurs d'indicateur et d'illuminateur exposés comme indiqué sur la photo 5, déconnectez-les et retirez le support de plaque d'immatriculation d'origine, en laissant les fils indiqués sur la photo 6. (Notez quels clignotants sont connectés aux côtés gauche et droit car ils doivent être reconnectés correctement lors de la reconnexion du support R&G.)
- Pour monter les clignotants d'origine, retirez les boulons qui les maintiennent au support de plaque d'immatriculation et dévissez les fils pour les libérer. En vous assurant qu'ils sont installés sur les bons côtés, ils peuvent ensuite être fixés au support de plaque R&G à l'aide des vis M6 et des écrous Nyloc fournis (articles 10 et 11).
- Assemblez le support arrière R&G comme indiqué sur la photo 7 et le schéma d'assemblage en utilisant les vis à tête fraisée M5, les rondelles M5 et les écrous nyloc M5 fournis. Assurez-vous que les écrous soient bien serrés.
- Fixez le feu de plaque d'immatriculation R&G (article 2) comme indiqué sur la photo 8.
- Utilisez la gaine thermo rétractable fournie (article 6) pour sceller les fils de l'éclairage de la plaque d'immatriculation.
- Insérez les 4 entretoises (article 5) dans les trous de montage comme indiqué sur le schéma de montage en veillant à ce que les côtés plats soient orientés vers le haut.
- Branchez le connecteur CON0065 de l'éclairage de plaque d'immatriculation (Article 13) comme indiqué sur la Photo 9, aux fils de l'éclairage en veillant à relier le noir au noir.
- Rebranchez les connecteurs de clignotant et de feu aux fils dépassant de l'embase de la moto. Assurez-vous que les clignotants gauche et droit soient correctement connectés. (Cela peut être vérifié en mettant le contact et en vérifiant qu'ils clignotent correctement.)
- Fixez le support arrière R&G à l'unité arrière de la moto en utilisant les mêmes 4 vis Torx qui ont été retirées du support de plaque d'immatriculation d'origine ainsi que les grandes rondelles M6 (article 12) fournies comme indiqué sur la photo 10.
- Les fils peuvent être rangés à l'aide des serre-câbles et des fentes pour serre-câbles dans le rangement arrière, comme indiqué sur la photo 11.

IMPORTANT : SI VOUS MONTEZ UNE PLAQUE D'IMMATRICULATION LARGE ET QUE VOUS LA PLACEZ ASSEZ BASSE SUR LE SUPPORT DE PLAQUE D'IMMATRICULATION, IL EST POSSIBLE QUE LA PLAQUE D'IMMATRICULATION TOUCHE LA ROUE ARRIÈRE SOUS UNE CHARGE LOURDE ET SUR DE GROSSES BOSSES SUR LA ROUTE. IL EST DE VOTRE RESPONSABILITÉ DE VÉRIFIER CETTE POSSIBILITÉ ET DE PRENDRE DES MESURES POUR ÉVITER. NE PAS VÉRIFIER CELA POURRAIT ENTRAÎNER DES BLESSURES GRAVES.

ISSUE 1 - 31/08/2022 - (DM)

R&G

Unit 1, Shelley's Lane, East Worldham, Alton, Hampshire, GU34 3AQ

Tel: +44 (0)1420 89007 Fax: +44 (0)1420 87301 www.rg-racing.com Email: info@rg-racing.com



CONSUMER NOTICE

The catalogue description and any exhibition of samples are only broad indications of the Products and R&G may make design changes which do not diminish their performance or visual appeal and supplying them in such state shall conform to the order. The Buyer acknowledges no representation or warranty (other than as to title) has been given or will apply to the Products other than those in R&G's order or confirmation and the Buyer confirms it has chosen the Products as being of merchantable quality and suitable for its particular purposes. Where R&G fits the Products or undertakes other services it shall exercise reasonable skill and care and rectify any fault free of charge unless the workmanship has been disturbed. The Buyer is responsible for ensuring that the warranty on the motorcycle is not affected by the fitting of the Products. On return of any defective Products R&G shall at its option either supply a replacement or refund the purchase money but shall not be liable if the Products have been modified or used or maintained otherwise than in accordance with R&G's or manufacturer's instructions and good engineering practice or if the defect arises from accident or neglect. Other than identified above and subject to R&G not limiting its liability for causing death and personal injury, it shall not be liable for indirect or consequential loss and otherwise its liability shall be limited to the amounts paid by the Buyer for the Products or the fitting or service concerned. These terms do not affect the Buyer's statutory rights.

R&G RACING RETURNS POLICY (NON-FAULTY GOODS)

Returns must be pre-authorized (if not pre-authorized the return will be rejected). Goods may only be returned direct to us if they were purchased direct from us (customer must prove if necessary). Otherwise to be returned to original vendor. Goods must be in re-sellable condition, in the opinion of R&G Racing. All returns are subject to a 25% restocking and handling fee (25% of the gross value exc. P&P – at the prevailing price at time of purchase). The customer must pay any and all carriage charges. No returns of discontinued products, unless within 14 days of purchase. This policy does not affect your statutory rights and does not refer to faulty goods.

R&G

Unit 1, Shelley's Lane, East Worldham, Alton, Hampshire, GU34 3AQ

Tel: +44 (0)1420 89007 Fax: +44 (0)1420 87301 www.rg-racing.com Email: info@rg-racing.com



MONTAGEANLEITUNG FÜR FE0320 KENNZEICHENHALTER



Alle Kit-Teile sind auf den nachfolgenden Seiten abgebildet und gekennzeichnet.

Die abgebildeten Teile dienen lediglich zur Erklärung.

Überprüfen Sie zuerst, dass alle Teile vorhanden sind.

Lesen Sie die Montageanleitung komplett durch, bevor Sie anfangen.

WENN SIE BEI DER MONTAGE DIESES PRODUKTES UNSICHER SIND, BITTE EINEN UNSERER HÄNDLER KONTAKTIEREN ODER DAS KIT VON EINEM QUALIFIZIERTEN ZWEIRAD-MECHANIKER MONTIEREN LASSEN.

Die Verpackung der Teile stellt nicht die Reihenfolge der Montage dar.

Hinweis für Kits mit Plastikunterlegscheiben an den Schrauben –
Diese Plastik-Unterlegscheiben werden nicht für den Einbau benötigt!

EINE DIGITALE VERSION DIESER MONTAGEANLEITUNG KANN AUF FOLGENDER SEITE HERUNTERGELADEN WERDEN:

WWW.RG-RACING.COM

R&G

Unit 1, Shelley's Lane, East Worldham, Alton, Hampshire, GU34 3AQ
Tel: +44 (0)1420 89007 Fax: +44 (0)1420 87301 www.rg-racing.com Email: info@rg-racing.com



<u>SIE BENÖTIGEN FOLGENDES WERKZEUG:</u>	<u>ALLGEM. ANZUGSDREHMOMENT:</u>
<ul style="list-style-type: none"> • Satz Torx-Schlüssel / Einsätze inkl. T20, T25, T30. • Satz Inbusschlüssel inkl. 3, 4, 5 & 6mm • 6 & 8mm Schraubenschlüssel oder Steckschlüssel • Kreuzschlitzschraubenzieher • Kl. Flachklingen-Schraubenzieher 	<p>M4 SCHRAUBE = 8Nm M5 SCHRAUBE = 12Nm M6 SCHRAUBE = 15Nm M8 SCHRAUBE = 20Nm M10 SCHRAUBE = 40Nm M12 SCHRAUBE = 40Nm</p>

LIEFERUMFANG

ARTIKEL NR.	BESCHREIBUNG	MENGE
ARTIKEL 1	FEP0320BK TEIL 3 - KENNZEICHENHALTER	1
ARTIKEL 2	LA0002 - KENNZEICHENBELEUCHTUNG	1
ARTIKEL 3	FEP0320BK TEIL 1 - HAUPTHALTERUNG RECHTS	1
ARTIKEL 4	FEP0320BK TEIL 2 - HAUPTHALTERUNG LINKS	1
ARTIKEL 5	S1360 - MONTAGE-ABSTANDSHALTER	4
ARTIKEL 6	150mm SCHRUMPFSCHLAUCH	1
ARTIKEL 7	M5x0.8x10.0 mm SENKSCHRAUBE	4
ARTIKEL 8	M5x10mm UNTERLEGSCHNEIBE	4
ARTIKEL 9	M5x0.8 SELBSTSICHERNDE MUTTER	4
ARTIKEL 10	M6x1.0x15mm INBUSSCHRAUBE	2
ARTIKEL 11	M6 X 12MM UNTERLEGSCHNEIBE	2
ARTIKEL 12	M6x19mm UNTERLEGSCHNEIBE	4
ARTIKEL 13	CON0065 - VERBINDER FÜR KENNZEICHENBELEUCHTUNG	1
ARTIKEL 14	M6 SELBSTSICHERNDE MUTTER	2
ARTIKEL 15	2.5mm KABELBINDER	4
ARTIKEL 16	CLIP 1 - SELBSTKLEBENDE KABELCLIPS	2
ARTIKEL 17	REFL 3 - RÜCKSTRAHLER	1

R&G

Unit 1, Shelley's Lane, East Worldham, Alton, Hampshire, GU34 3AQ

Tel: +44 (0)1420 89007 Fax: +44 (0)1420 87301 www.rg-racing.com Email: info@rg-racing.com



ZEICHNUNG - ZUSAMMENBAU

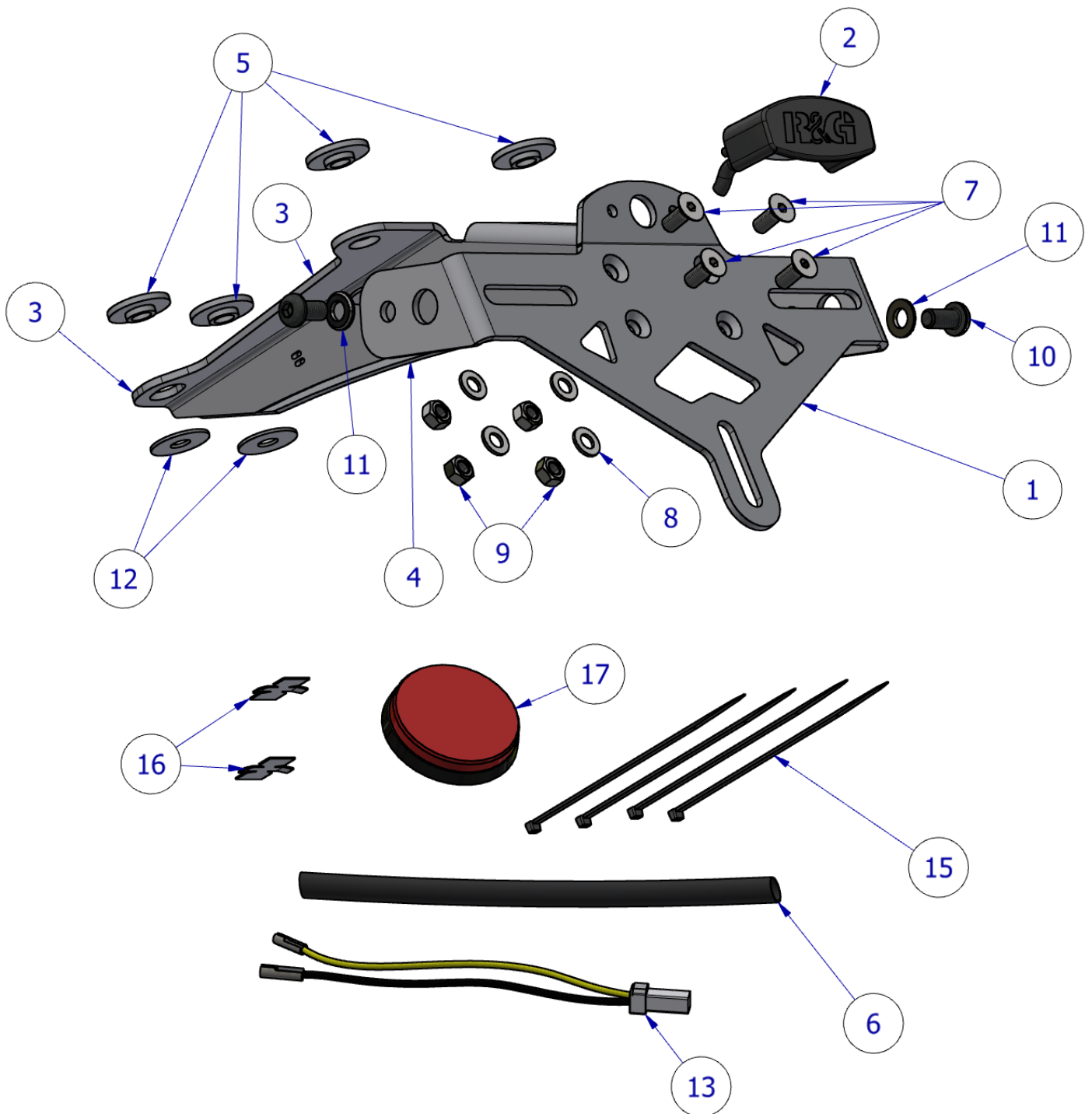

R&G

Unit 1, Shelley's Lane, East Worldham, Alton, Hampshire, GU34 3AQ

Tel: +44 (0)1420 89007 Fax: +44 (0)1420 87301 www.rg-racing.com Email: info@rg-racing.com



MONTAGE - ABBILDUNGEN



Abbildung 1



Abbildung 2



Abbildung 3



Abbildung 4



Abbildung 5



Abbildung 6

R&G



Abbildung 7

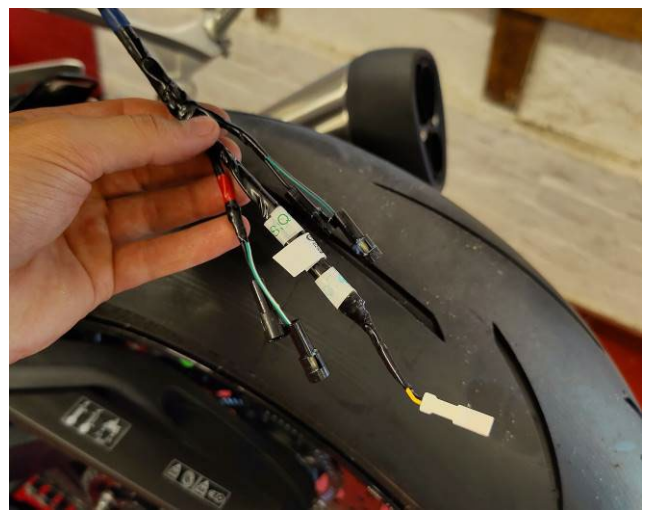

Abbildung 8



Abbildung 9



Abbildung 10

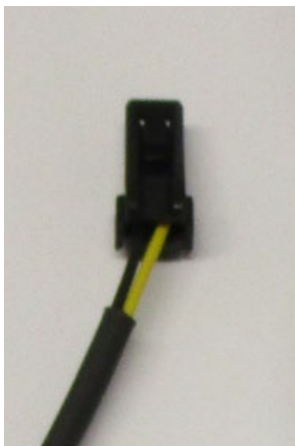

Abbildung 11



MONTAGEANLEITUNG

- Zuerst die Schrauben, die den original Kennzeichenhalter am Heck des Motorrades befestigen mit einem T20 Torx-Schlüssel entfernen – siehe **Abbildung 1**.
- Danach ist der Kennzeichenhalter locker und nur noch mit den Kabeln für die Blinker verbunden. Stützen Sie den Kennzeichenhalter, sodass die Kabel nicht beschädigt werden können – siehe **Abbildung 2**.
- Die Abdeckung aus Kunststoff vorsichtig rausziehen und entfernen – siehe **Abbildung 3**.
- Danach sehen Sie die 2 Schrauben, die in **Abbildung 4** abgebildet sind. Entfernen Sie diese Schrauben mit einem T20 Torx-Schlüssel, um den Kennzeichenhalter in zwei Teile zu trennen.
- Die übrigen Kunststoff-Abdeckungen können nun ebenfalls entfernt werden.
- Die Verbindungen für die Blinker und die Beleuchtung liegen jetzt frei – siehe **Abbildung 5**, trennen Sie sie und entfernen Sie den original Kennzeichenhalter – die Kabel bleiben wie in **Abbildung 6** abgebildet (notieren Sie wie die Blinker verbunden sind, um die Verbindung mit dem R&G Kennzeichenhalter später zu vereinfachen).
- Um die Originalblinker zu montieren, entfernen Sie die Schrauben, die sie am Kennzeichenhalter befestigen und die Kabel ausfädeln. Danach am R&G Kennzeichenhalter mit den M6 Schrauben und selbstsichernden Muttern vom Kit (**Artikel 10 & 11**) montieren – bitte darauf achten, dass sie an der jeweils richtigen Seite montiert sind.
- Den R&G Kennzeichenhalter zusammenbauen wie in **Abbildung 7** und in der **Zeichnung Zusammenbau** abgebildet mit den M5 Senkschrauben, M5 Unterlegscheiben und M5 selbstsichernden Muttern vom Kit und kontrollieren Sie, dass die Muttern festgezogen sind.
- Die R&G Kennzeichenbeleuchtung (**Artikel 2**) montieren wie in **Abbildung 8** abgebildet.
- Den mitgelieferten Schrumpfschlauch (**Artikel 6**) anbringen, um die Kabel für die Kennzeichenbeleuchtung zu schützen.
- Die 4 Distanzhalter (**Artikel 5**) in die Montageöffnungen einsetzen wie in der **Zeichnung Zusammenbau** abgebildet – bitte darauf achten, dass die flache Seite nach oben gerichtet ist.
- Verbinden Sie den CON0065 Verbinder für die Kennzeichenbeleuchtung (**Artikel 13**) wie in **Abbildung 9** abgebildet und stellen Sie sicher, dass die Kabel wie folgt verbunden sind: schwarz mit schwarz.
- Verbinden Sie die Verbinder für die Blinker und die Kennzeichenbeleuchtung wieder mit den Kabeln, die am Heck hervorstehen. Stellen Sie sicher, dass die Blinker ordnungsgemäß verbunden sind.
- Den R&G Kennzeichenhalter am Heck des Motorrades montieren mit den 4 Torx-Schrauben, die vom original Kennzeichenhalter entfernt wurden und den großen M6 Unterlegscheiben vom Kit (**Artikel 12**) wie in **Abbildung 10** abgebildet.
- Die Kabel ordentlich befestigen mit den mitgelieferten Kabelbindern an den dafür vorgesehenen Öffnungen - siehe **Abbildung 11**.

WICHTIG: AUS SICHERHEITSGRÜNDEN STELLEN SIE SICHER, DASS DAS KENNZEICHEN SO HOCH WIE MÖGLICH AM KENNZEICHENHALTER ANGEBRACHT WIRD (BOHRUNGEN IM KENNZEICHEN EVTL. NOTWENDIG). WENN SIE EIN KENNZEICHEN MIT 200MM ODER GRÖßER (INKL. ABDECKUNG ODER RÜCKSTRAHLER) MONTIEREN, DAS MOTORRAD KOMPLETT EINFEDERN, UM SICHERZUSTELLEN, DASS KEINE TEILE DAS HINTERRAD BERÜHREN KÖNNEN, WENN DAS MOTORRAD IN BEWEGUNG ODER UNTER SCHWERER LAST IST. ES LIEGT IN IHRER VERANTWORTUNG DIES ZU ÜBERPRÜFEN UND, WENN NOTWENDIG, DIE ENTSPRECHENDEN SCHRITTE VORZUNEHMEN. DIE NICHTBEACHTUNG DIESER SICHERHEITSHINWEISES KANN ZU SCHWEREN VERLETZUNGEN FÜHREN.

AUSGABE 1 - 31/08/2022 - (DM)

R&G

Unit 1, Shelley's Lane, East Worldham, Alton, Hampshire, GU34 3AQ

Tel: +44 (0)1420 89007 Fax: +44 (0)1420 87301 www.rg-racing.com Email: info@rg-racing.com



CONSUMER NOTICE

The catalogue description and any exhibition of samples are only broad indications of the Products and R&G may make design changes which do not diminish their performance or visual appeal and supplying them in such state shall conform to the order. The Buyer acknowledges no representation or warranty (other than as to title) has been given or will apply to the Products other than those in R&G's order or confirmation and the Buyer confirms it has chosen the Products as being of merchantable quality and suitable for its particular purposes. Where R&G fits the Products or undertakes other services it shall exercise reasonable skill and care and rectify any fault free of charge unless the workmanship has been disturbed. The Buyer is responsible for ensuring that the warranty on the motorcycle is not affected by the fitting of the Products. On return of any defective Products R&G shall at its option either supply a replacement or refund the purchase money but shall not be liable if the Products have been modified or used or maintained otherwise than in accordance with R&G's or manufacturer's instructions and good engineering practice or if the defect arises from accident or neglect. Other than identified above and subject to R&G not limiting its liability for causing death and personal injury, it shall not be liable for indirect or consequential loss and otherwise its liability shall be limited to the amounts paid by the Buyer for the Products or the fitting or service concerned. These terms do not affect the Buyer's statutory rights.

R&G RACING RETURNS POLICY (NON-FAULTY GOODS)

Returns must be pre-authorized (if not pre-authorized the return will be rejected). Goods may only be returned direct to us if they were purchased direct from us (customer must prove if necessary). Otherwise to be returned to original vendor. Goods must be in re-sellable condition, in the opinion of R&G Racing. All returns are subject to a 25% restocking and handling fee (25% of the gross value exc. P&P – at the prevailing price at time of purchase). The customer must pay any and all carriage charges. No returns of discontinued products, unless within 14 days of purchase. This policy does not affect your statutory rights and does not refer to faulty goods.

R&G

Unit 1, Shelley's Lane, East Worldham, Alton, Hampshire, GU34 3AQ

Tel: +44 (0)1420 89007 Fax: +44 (0)1420 87301 www.rg-racing.com Email: info@rg-racing.com