



**FITTING INSTRUCTIONS FOR CR0033BK OFFSET COTTON REELS**  
**BMW S1000 RR 2010**



**THIS KIT CONTAINS THE ITEMS PICTURED AND LABELLED BELOW.**  
**DO NOT PROCEED UNTIL YOU ARE SURE ALL PARTS ARE PRESENT.**

**Please note that the way the kit is packed does not necessarily represent the way of mounting to the bike**  
**THE PARTS SHOWN MAY BE REPRESENTATIVE ONLY (FOR CLARITY OF INSTRUCTIONS ONLY)**

**LEFT HAND  
SIDE**

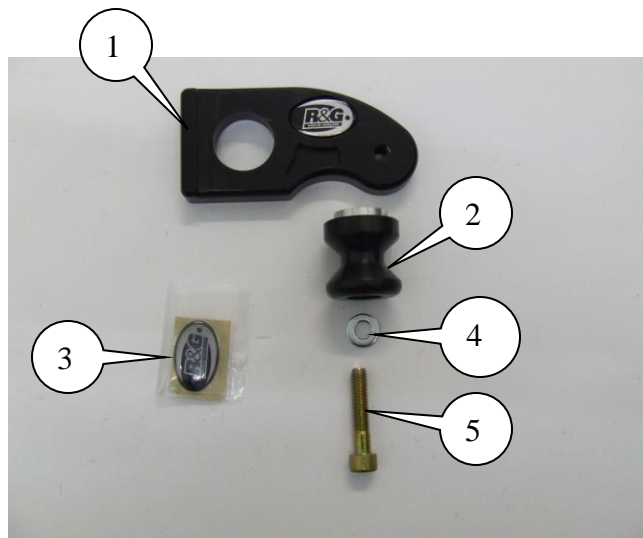



## RIGHT HAND SIDE

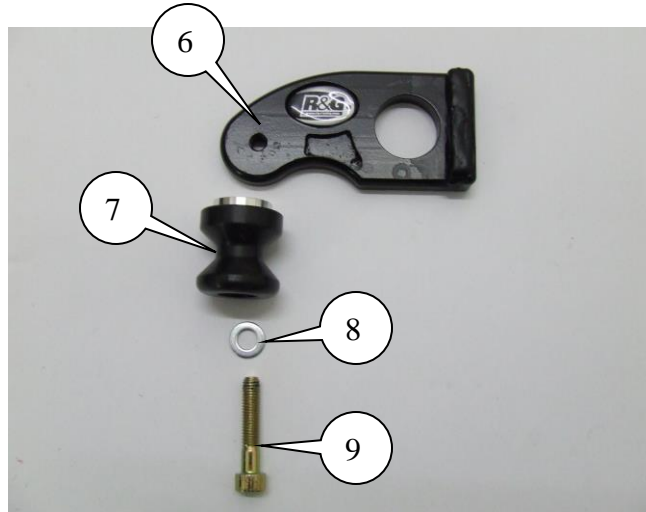

### **LEGEND**

- ITEM 1 = LEFT HAND SIDE REPLACEMENT ADJUSTER BLOCK/COTTON REEL MOUNT (x1).  
ITEM 2 = COTTON REEL (B0300) FITTED WITH COMPRESION SLEEVE (CS300) (x1).  
ITEM 3 = BUBBLE STICKERS (RGS0005) (x6).  
ITEM 4 = 8mm WASHERS 16mm OUTSIDE DIAMETER (x1).  
ITEM 5 = M8x1.25x40mm LONG CAP HEAD BOLT (x1).  
ITEM 6 = RIGHT HAND SIDE REPLACEMENT ADJUSTER BLOCK/COTTON REEL MOUNT (x1).  
ITEM 7 = COTTON REEL (B0300) FITTED WITH COMPRESION SLEEVE (CS300) (x1).  
ITEM 8 = 8mm WASHERS 16mm OUTSIDE DIAMETER (x1).  
ITEM 9 = M8x1.25x40mm LONG CAP HEAD BOLT (x1).

Please note that in cases where kits are packed with rubber washers holding the components onto the bolt – *the rubber washers should be thrown away!*

### **TOOLS REQUIRED**

- 6mm A/F ALLEN KEY.
- 34mm A/F SOCKET AND WRENCH.
- TORQUE WRENCH TO BE USED AT 100Nm.
- PADDOCK STAND.

### **FITTING INSTRUCTIONS**

Please read all instructions before commencing fitting

- Raise rear of bike on original paddock stand bobbins, support rear wheel (suggest using blocks of wood) to prevent wheel from dropping when rear spindle is removed.
- Undo the rear spindle nut.
- Remove the rear spindle.

R&G Racing

Unit 1, Shelley's Lane, East Worldham, Alton, Hampshire, GU34 3AQ

Tel: +44 (0)1420 89007 Fax: +44 (0)1420 87301 [www.rg-racing.com](http://www.rg-racing.com) Email: [info@rg-racing.com](mailto:info@rg-racing.com)



- Remove the OEM chain adjuster blocks.
- Place the new right hand adjuster block/cotton reel mount (this is the thinner adjuster block/cotton reel mount it is the same thickness as the original adjuster block) onto the rear wheel spindle as original.
- Slide spindle through the swing arm, brake calliper and rear wheel.
- Place the remaining thicker adjuster block/cotton reel mount over the exposed spindle and into adjuster slot.
- Refit the spindle washer and nut and tighten according to the manufactures instructions (100Nm) and check chain adjustment.
- Fit the new cotton reels to the new adjuster blocks on both sides as shown in pictures 1 and 2.
- Fit bubble stickers if not already fitted.
- Remove bike from the paddock stand.

#### **CONSUMER NOTICE**

The catalogue description and any exhibition of samples are only broad indications of the Products and R&G may make design changes which do not diminish their performance or visual appeal and supplying them in such state shall conform to the order. The Buyer acknowledges no representation or warranty (other than as to title) has been given or will apply to the Products other than those in R&G's order or confirmation and the Buyer confirms it has chosen the Products as being of merchantable quality and suitable for its particular purposes. Where R&G fits the Products or undertakes other services it shall exercise reasonable skill and care and rectify any fault free of charge unless the workmanship has been disturbed. The Buyer is responsible for ensuring that the warranty on the motorcycle is not affected by the fitting of the Products. On return of any defective Products R&G shall at its option either supply a replacement or refund the purchase money but shall not be liable if the Products have been modified or used or maintained otherwise than in accordance with R&G's or manufacturer's instructions and good engineering practice or if the defect arises from accident or neglect. Other than identified above and subject to R&G not limiting its liability for causing death and personal injury, it shall not be liable for indirect or consequential loss and otherwise its liability shall be limited to the amounts paid by the Buyer for the Products or the fitting or service concerned. These terms do not affect the Buyer's statutory rights.

#### **R&G RACING RETURNS POLICY (NON-FAULTY GOODS)**

Returns must be pre-authorized (if not pre-authorized the return will be rejected). Goods may only be returned direct to us if they were purchased direct from us (customer must prove if necessary). Otherwise to be returned to original vendor. Goods must be in re-sellable condition, in the opinion of R&G Racing. All returns are subject to a 25% restocking and handling fee (25% of the gross value exc. P&P – at the prevailing price at time of purchase). The customer must pay any and all carriage charges. No returns of discontinued products, unless within 14 days of purchase. This policy does not affect your statutory rights and does not refer to faulty goods.



**FRANCE**  
**INSTRUCTIONS DE MONTAGE CR0033BK**  
**BMW S1000 RR 2010**

**LA PRESENTATION DES PIECES R&G DANS L'EMBALLAGE N'EST PAS TOUJOURS IDENTIQUE AU SENS DE MONTAGE.**

**Merci de noter que dans le cas où les protections sont assemblées avec une bague en caoutchouc, merci de bien vouloir le retirer lors du montage des pièces sur la moto.**

**Merci de lire la notice de montage avant de commencer le montage de la pièce.**

**LEGEND**

- 1= Pièce côté Gauche (x1).
- 2= Tampon/diabolos (x1).
- 3= Autocollant R&G (x6).
- 4= Rondelle dia 8mm (x1).
- 5= Vis M8x1.25x40mm (x1).
- 6= Pièce côté Droit (x1).
- 7= Tampon/diabolos (x1).
- 8= Rondelle dia 8mm (x1).
- 9= Vis M8x1.25x40mm (x1).

**OUTILS NECESSAIRES**

- Clé Allen de 6 mm .
- Clé de 34 mm.
- Clé dynamométrique 100Nm.
- PADDOCK STAND.

**LIRE LA NOTICE AVANT DE MONTER LES PIECES SUR LA MOTO.**

- Lever l'arrière de la moto à l'aide d'une béquille de stand d'atelier
- Mettre une cale sous le pneu arrière, de manière à laisser la roue en position lors du démontage de l'axe arrière.
- Enlever l'écrou d'axe de roue arrière.
- Enlever l'axe de roue.
- Enlever les tendeurs de chaîne d'origine
- Placer le bloc R&G le plus fin sur l'axe de roue.
- Remonter l'axe sur la moto, attention de commencer par le côté droit.
- Placer la seconde pièce en alu sur le côté gauche de l'axe.
- Remonter la rondelle et l'écrou d'origine sur l'axe de roue arrière. Faire le réglage de tension de chaîne, puis serrer l'écrou de l'axe au couple de serrage d'origine. (100 nm)
- Ouvrir la béquille latérale de la moto.
- Puis enlever la béquille de stand.
- Monter les protections sur les prolongateurs R&G. (placer une rondelle M8 sur les vis M8 et glisser le tout à travers les tampons.)
- Mettre les stickers sur les pièces en aluminium R&G.