



FITTING INSTRUCTIONS FOR CP0544BL AERO CRASH PROTECTORS
SUZUKI GSX-S1000 GT 2022-



THIS KIT CONTAINS THE ITEMS PICTURED AND LABELLED OVER PAGE.

SOME PARTS MAY BE SHOWN FOR CLARITY OF INSTRUCTIONS ONLY.

DO NOT PROCEED UNTIL YOU ARE SURE ALL PARTS ARE PRESENT.

PLEASE READ ALL INSTRUCTIONS BEFORE PROCEEDING.

**IF IN ANY DOUBT WHEN FITTING OUR PRODUCTS, CONSULT ONE OF OUR DEALERS OR
HAVE FITTED BY A QUALIFIED TECHNICIAN.**

PLEASE NOTE THAT THE WAY THE KIT IS PACKED DOES NOT NECESSARILY REPRESENT THE WAY OF
MOUNTING TO THE BIKE.

IN THE EVENT OF RUBBER WASHERS BEING USED TO HOLD COMPONENTS ONTO BOLTS,
THESE RUBBER WASHERS CAN BE THROWN AWAY.

DIGITAL COPIES OF THESE INSTRUCTIONS ARE AVAILABLE TO DOWNLOAD FROM
[WWW.RG-RACING.COM](http://www.rg-racing.com)



<u>TOOLS REQUIRED</u>	<u>GENERAL TORQUE SETTINGS</u>
<ul style="list-style-type: none"> • 8mm ALLEN KEY • 17mm SOCKET AND EITHER A 3/8" OR 1/2" WRENCH. • TORQUE WRENCH CAPABLE OF 40Nm. • SUITABLE JACK WITH SOFT SUPPORT AREA (TO SUPPORT ENGINE WHILE MOUNTING BOLTS REMOVED). 	<p>M4 BOLT = 8Nm M5 BOLT = 12Nm M6 BOLT = 15Nm M8 BOLT = 20Nm M10 BOLT = 40Nm M12 BOLT = 40Nm</p>

LEGEND

ITEM NO.	DESCRIPTION	QTY
ITEM 1	B0431 WITH CS341 (BOBBIN)	2
ITEM 2	BC0002 (BOBBIN CAP)	2
ITEM 3	S1090 (LHS SPACER – 22mm LONG x 10.5mm ID x 21mm OD)	1
ITEM 4	S0798 (RHS SPACER – 23mm LONG x 10.5mm ID x 22.5mm OD)	1
ITEM 5	M10 x 1.25 x 110mm HEX HEAD BOLT (LHS BOBBIN BOLT)	1
ITEM 6	M10 x 1.25 x 120mm HEX HEAD BOLT (RHS BOBBIN BOLT)	1
ITEM 7	M10 x 20mm OD WASHER	2
ITEM 8	M12 EXTERNAL SHAKEPROOF WASHER	2

R&G

Unit 1, Shelley's Lane, East Worldham, Alton, Hampshire, GU34 3AQ

Tel: +44 (0)1420 89007 Fax: +44 (0)1420 87301 www.rg-racing.com Email: info@rg-racing.com



ASSEMBLY DIAGRAM – LHS

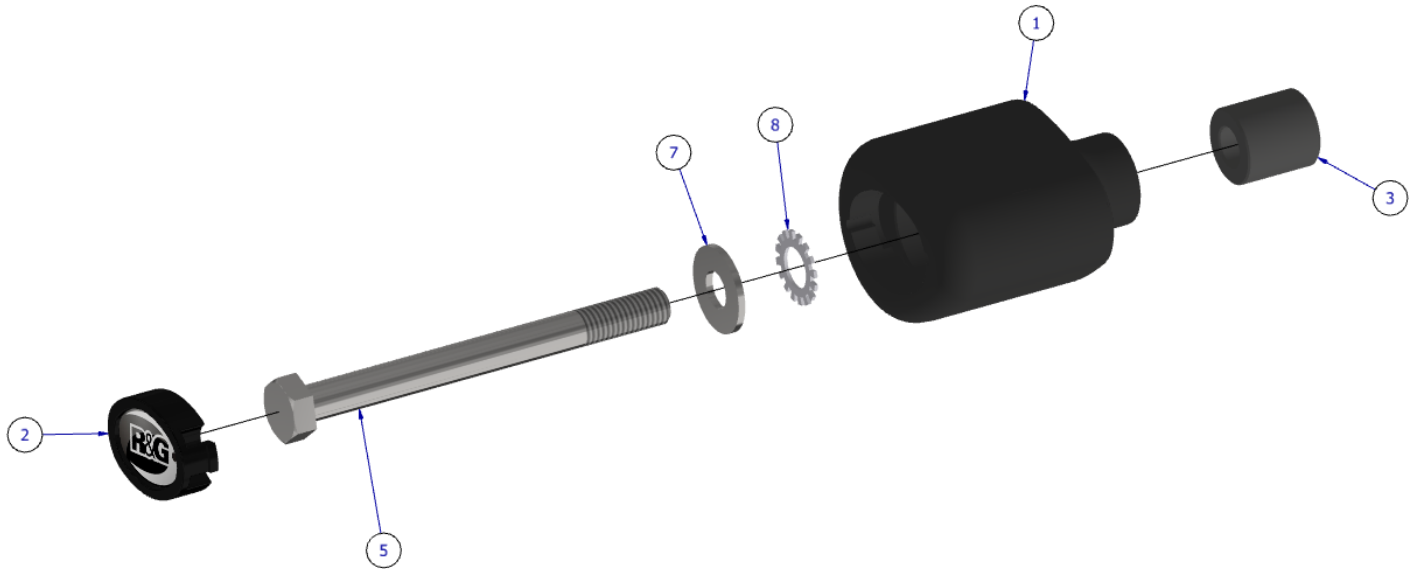

ASSEMBLY DIAGRAM - RHS

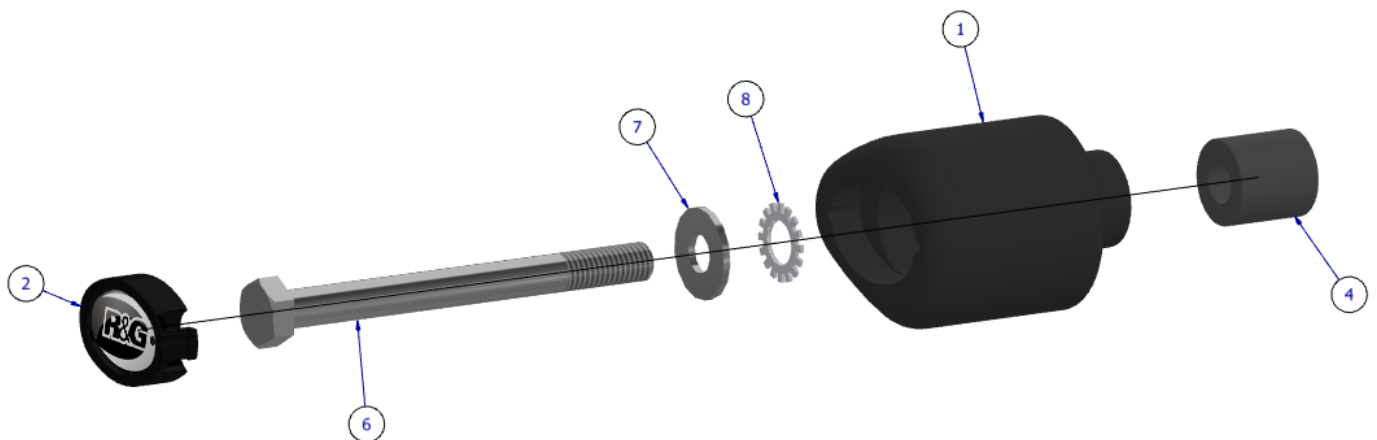

R&G

Unit 1, Shelley's Lane, East Worldham, Alton, Hampshire, GU34 3AQ

Tel: +44 (0)1420 89007 Fax: +44 (0)1420 87301 www.rg-racing.com Email: info@rg-racing.com



AERO-STYLE CRASH PROTECTOR ORIENTATION



FITTING PICTURES



Picture 1



Picture 2



FITTING INSTRUCTIONS

PLEASE NOTE THAT BEFORE BEGINNING, YOU WILL NEED A SUITABLE JACK TO SUPPORT THE ENGINE WHEN REMOVING OEM ENGINE BOLTS. IF YOU ARE NOT COMFORTABLE CARRYING OUT THIS PROCEDURE, HAVE FITTED BY A QUALIFIED TECHNICIAN. READ ALL STEPS BEFORE PROCEEDING.

- Place the jack underneath the engine in a central position and apply a light pressure to the underside of the engine **NOT** the exhaust or any other tubing (Please use a semi soft material (rubber/wood etc) as a bumper between the jack support area & the engine to cushion/spread the load which prevent any damage to the under-side of the engine).
- As shown in **Picture 1** please remove the LHS OEM engine bolt.
- Construct the LHS assembly as shown above in **ASSEMBLY DIAGRAM – LHS.**
- Attach the LHS assembly using the M10 x 1.25 x 110mm bolt provided (**Item 5**) tightening to the torque spec noted above.
- As shown in **Picture 2** please remove the RHS OEM engine bolt.
- Construct the RHS assembly as shown above in **ASSEMBLY DIAGRAM – RHS.**
- Attach the RHS assembly using the M10 x 1.25 x 120mm bolt provided (**Item 6**), tightening to the torque spec noted above.
- Lastly, please ensure all bolts are correctly tightened before riding the motorcycle.

ISSUE 1 - 27/05/2022 (AO)

CONSUMER NOTICE

The catalogue description and any exhibition of samples are only broad indications of the Products and R&G may make design changes which do not diminish their performance or visual appeal and supplying them in such state shall conform to the order. The Buyer acknowledges no representation or warranty (other than as to title) has been given or will apply to the Products other than those in R&G's order or confirmation and the Buyer confirms it has chosen the Products as being of merchantable quality and suitable for its particular purposes. Where R&G fits the Products or undertakes other services it shall exercise reasonable skill and care and rectify any fault free of charge unless the workmanship has been disturbed. The Buyer is responsible for ensuring that the warranty on the motorcycle is not affected by the fitting of the Products. On return of any defective Products R&G shall at its option either supply a replacement or refund the purchase money but shall not be liable if the Products have been modified or used or maintained otherwise than in accordance with R&G's or manufacturer's instructions and good engineering practice or if the defect arises from accident or neglect. Other than identified above and subject to R&G not limiting its liability for causing death and personal injury, it shall not be liable for indirect or consequential loss and otherwise its liability shall be limited to the amounts paid by the Buyer for the Products or the fitting or service concerned. These terms do not affect the Buyer's statutory rights.

R&G RETURNS POLICY (NON-FAULTY GOODS)

Returns must be pre-authorized (if not pre-authorized the return will be rejected). Goods may only be returned direct to us if they were purchased direct from us (customer must prove if necessary). Otherwise to be returned to original vendor. Goods must be in re-sellable condition, in the opinion of R&G. All returns are subject to a 25% restocking and handling fee (25% of the gross value exc. P&P – at the prevailing price at time of purchase). The customer must pay any and all carriage charges. No returns of discontinued products, unless within 14 days of purchase. This policy does not affect your statutory rights and does not refer to faulty goods.

R&G

Unit 1, Shelley's Lane, East Worldham, Alton, Hampshire, GU34 3AQ

Tel: +44 (0)1420 89007 Fax: +44 (0)1420 87301 www.rg-racing.com Email: info@rg-racing.com



NOTICE DE MONTAGE POUR CP0544BL PROTECTIONS CRASH
SUZUKI GSX-S1000 GT 2022-

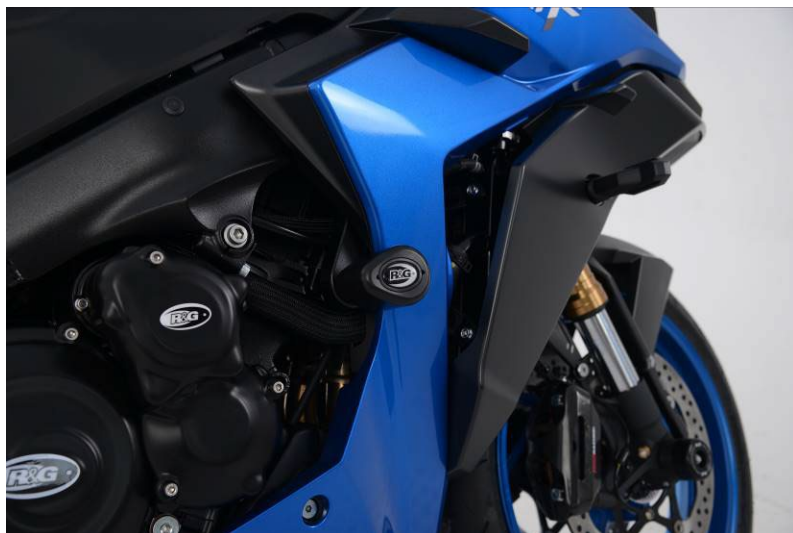

CE KIT CONTIENT LES ARTICLES ILLUSTRÉS ET ÉTIQUETES SUR LA PAGE.

CERTAINES PARTIES PEUVENT ÊTRE PRÉSENTES UNIQUEMENT POUR LA CLARTÉ DES INSTRUCTIONS.

NE PAS PROCÉDER AU MONTAGE TANT QUE VOUS N'ÊTES PAS SÛR QUE TOUTES LES PIÈCES SOIENT PRÉSENTES.

VEUILLEZ LIRE TOUTES LES INSTRUCTIONS AVANT DE CONTINUER.

**EN CAS DE DOUTE LORS DU MONTAGE DE NOS PRODUITS, CONSULTEZ UN DE NOS
REVENDEURS OU FAITES APPEL À UN TECHNICIEN QUALIFIÉ.**

VEUILLEZ NOTER QUE LA FAÇON DONT LE KIT EST EMBALLÉ NE REPRÉSENTE PAS NECESSAIREMENT LA
MANIÈRE DE LE MONTER SUR LA MOTO.

SI DES RONDELLES EN CAOUTCHOUC SONT UTILISÉES POUR MAINTENIR LES COMPOSANTS SUR LES
BOULONS, ELLES PEUVENT ÊTRE JETÉES.

NOTICE DISPONIBLE AU TÉLÉCHARGEMENT SUR : WWW.RG-RACING.COM

R&G

Unit 1, Shelley's Lane, East Worldham, Alton, Hampshire, GU34 3AQ

Tel: +44 (0)1420 89007 Fax: +44 (0)1420 87301 www.rg-racing.com Email: info@rg-racing.com



<u>OUTILS REQUIS</u>	<u>VALEURS DE SERRAGE</u>
<ul style="list-style-type: none"> • CLÉ ALLEN 8mm • CLÉ À CLIQUET 17mm ET DOUILLES DE 3/8" OU 1/2". • CLÉ DYNAMOMÉTRIQUE (à 40Nm) • PRISE ADAPTÉE POUR SUPPORTER LE MOTEUR LORSQUE LES BOULONS MOTEUR SERON ENLEVÉS). 	M4 BOULON = 8Nm M5 BOULON = 12Nm M6 BOULON = 15Nm M8 BOULON = 20Nm M10 BOULON = 40Nm M12 BOULON = 40Nm

LÉGENDE

ARTICLE NO.	DESCRIPTION	QTÉ
ARTICLE 1	B0431 AVEC CS341 (BOBINE)	2
ARTICLE 2	BC0002 (CAPUCHON DE BOBINE)	2
ARTICLE 3	S1090 (ENTRETOISE CÔTÉ GAUCHE - 22mm DE LONG x 10.5mm ID x 21mm OD)	1
ARTICLE 4	S0798 (ENTRETOISE CÔTÉ DROIT - 23mm DE LONG x 10.5mm ID x 22.5mm OD)	1
ARTICLE 5	M10 x 1.25 x 110mm BOULON (BOULON DE BOBINE GAUCHE)	1
ARTICLE 6	M10 x 1.25 x 120mm BOULON (BOULON DE BOBINE DROIT)	1
ARTICLE 7	M10 x 20mm RONDELLE	2
ARTICLE 8	M12 RONDELLE EXTERNE ANTI-VIBRATION	2

R&G

Unit 1, Shelley's Lane, East Worldham, Alton, Hampshire, GU34 3AQ

Tel: +44 (0)1420 89007 Fax: +44 (0)1420 87301 www.rg-racing.com Email: info@rg-racing.com



SCHÉMA D'ENSEMBLE – CÔTÉ GAUCHE



SCHÉMA D'ENSEMBLE – CÔTÉ DROIT



R&G

Unit 1, Shelley's Lane, East Worldham, Alton, Hampshire, GU34 3AQ

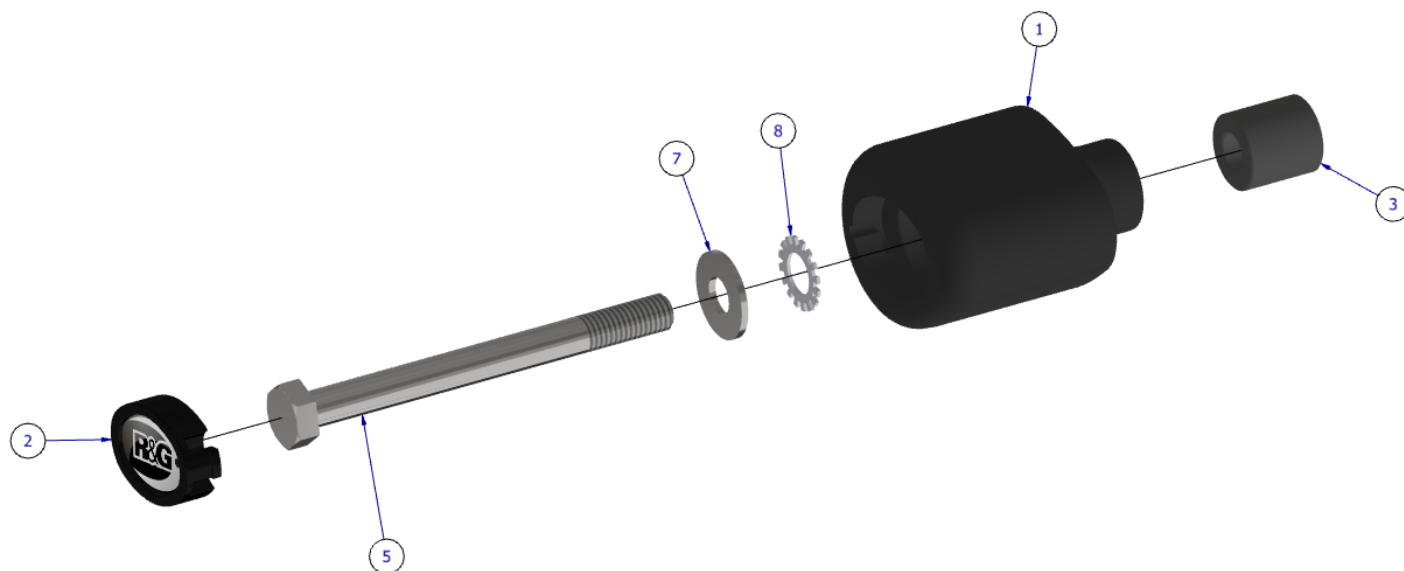
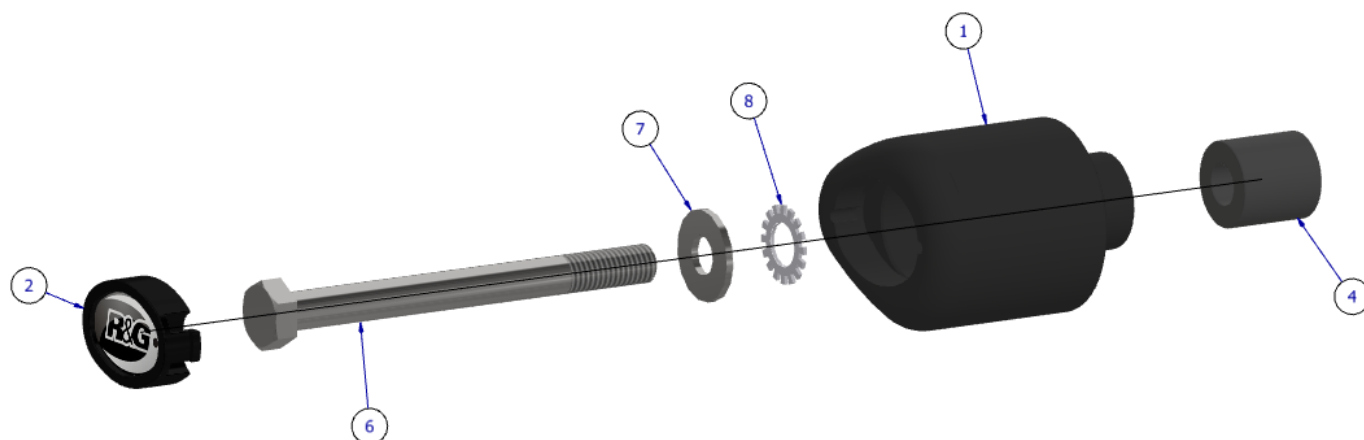
Tel: +44 (0)1420 89007 Fax: +44 (0)1420 87301 www.rg-racing.com Email: info@rg-racing.com



ORIENTATION DE LA PROTECTION CRASH



PHOTOS DE MONTAGE

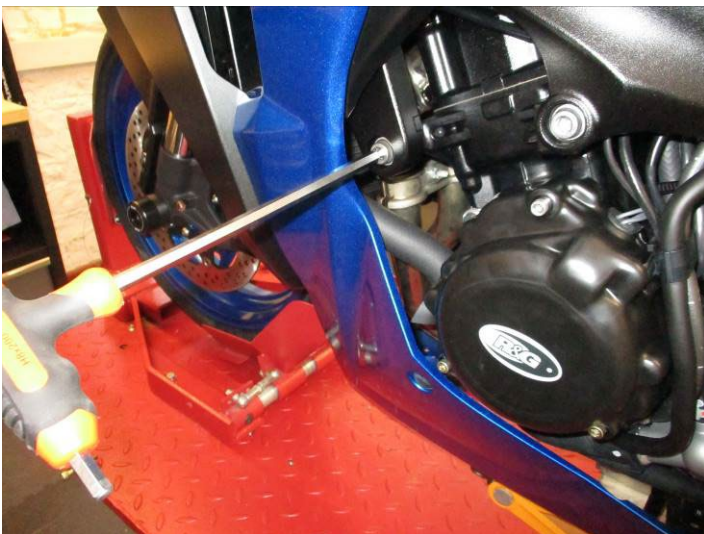

Photo 1



Photo 2



NOTICE DE MONTAGE

VEUILLEZ NOTER QU'AVANT DE COMMENCER, VOUS AUREZ BESOIN D'UN CRIC APPROPRIÉ POUR SOUTENIR LE MOTEUR LORSQUE VOUS ENLEVEZ LES BOULONS MOTEUR D'ORIGINE. SI VOUS N'ÊTES PAS À L'AISE POUR EFFECTUER CETTE PROCÉDURE, FAITES FAIRE L'INSTALLATION PAR UN TECHNICIEN QUALIFIÉ. LISEZ TOUTES LES ÉTAPES AVANT DE CONTINUER.

- Placez le cric sous le moteur dans une position centrale et appliquez une légère pression sur le dessous du moteur ET NON sur l'échappement ou tout autre tube (veuillez utiliser un matériau semi-souple (caoutchouc/bois, etc.) comme pare-chocs entre la zone de support du cric & le moteur pour amortir/répartir la charge, ce qui évite tout dommage au-dessous du moteur).
- Comme indiqué sur la photo 1, veuillez retirer le boulon du moteur d'origine côté gauche.
- Montez l'ensemble côté gauche comme indiqué ci-dessus dans SCHÉMA D'ASSEMBLAGE – GAUCHE.
- Fixez l'ensemble côté gauche à l'aide du boulon M10 x 1,25 x 110 mm fourni (article 5) en serrant au couple indiqué ci-dessus.
- Comme indiqué sur la photo 2, veuillez retirer le boulon du moteur côté droit d'origine.
- Montez l'ensemble côté droit comme indiqué ci-dessus dans SCHÉMA D'ASSEMBLAGE – DROIT.
- Fixez l'ensemble côté droit à l'aide du boulon M10 x 1,25 x 120 mm fourni (article 6), en serrant au couple spécifié ci-dessus.
- Enfin, assurez-vous que tous les boulons soient correctement **serrés avant de piloter la moto.**

ISSUE 1 - 27/05/2022 (AO)

CONSUMER NOTICE

The catalogue description and any exhibition of samples are only broad indications of the Products and R&G may make design changes which do not diminish their performance or visual appeal and supplying them in such state shall conform to the order. The Buyer acknowledges no representation or warranty (other than as to title) has been given or will apply to the Products other than those in R&G's order or confirmation and the Buyer confirms it has chosen the Products as being of merchantable quality and suitable for its particular purposes. Where R&G fits the Products or undertakes other services it shall exercise reasonable skill and care and rectify any fault free of charge unless the workmanship has been disturbed. The Buyer is responsible for ensuring that the warranty on the motorcycle is not affected by the fitting of the Products. On return of any defective Products R&G shall at its option either supply a replacement or refund the purchase money but shall not be liable if the Products have been modified or used or maintained otherwise than in accordance with R&G's or manufacturer's instructions and good engineering practice or if the defect arises from accident or neglect. Other than identified above and subject to R&G not limiting its liability for causing death and personal injury, it shall not be liable for indirect or consequential loss and otherwise its liability shall be limited to the amounts paid by the Buyer for the Products or the fitting or service concerned. These terms do not affect the Buyer's statutory rights.

R&G RETURNS POLICY (NON-FAULTY GOODS)

Returns must be pre-authorized (if not pre-authorized the return will be rejected). Goods may only be returned direct to us if they were purchased direct from us (customer must prove if necessary). Otherwise to be returned to original vendor. Goods must be in re-sellable condition, in the opinion of R&G. All returns are subject to a 25% restocking and handling fee (25% of the gross value exc. P&P – at the prevailing price at time of purchase). The customer must pay any and all carriage charges. No returns of discontinued products, unless within 14 days of purchase. This policy does not affect your statutory rights and does not refer to faulty goods.

R&G

Unit 1, Shelley's Lane, East Worldham, Alton, Hampshire, GU34 3AQ

Tel: +44 (0)1420 89007 Fax: +44 (0)1420 87301 www.rg-racing.com Email: info@rg-racing.com



MONTAGEANLEITUNG FÜR CP0544BL AERO STURZPADS
SUZUKI GSX-S1000 GT 2022-



ALLE KIT-TEILE SIND AUF DEN NACHFOLGENDEN SEITEN ABGEBILDET UND GEKENNZEICHNET.

DIE ABGEBILDETEN TEILE DIENEN LEDIGLICH ZUR ERKLÄRUNG.

ÜBERPRÜFEN SIE ZUERST, DASS ALLE TEILE VORHANDEN SIND.

LESEN SIE DIE MONTAGEANLEITUNG KOMPLETT DURCH, BEVOR SIE ANFANGEN.

WENN SIE BEI DER MONTAGE DIESES PRODUKTES UNSICHER SIND, BITTE EINEN UNSERER HÄNDLER KONTAKTIEREN ODER DAS KIT VON EINEM QUALIFIZIERTEN ZWEIRAD-MECHANIKER MONTIEREN LASSEN.

DIE VERPACKUNG DER TEILE STELLT NICHT DIE REIHENFOLGE DER MONTAGE DAR.

HINWEIS FÜR KITS MIT PLASTIKUNTERLEGSCHLEIBEN AN DEN SCHRAUBEN –
DIESE PLASTIK-UNTERLEGSCHLEIBEN WERDEN NICHT FÜR DEN EINBAU BENÖTIGT.

EINE DIGITALE VERSION DIESER MONTAGEANLEITUNG KANN AUF FOLGENDER SEITE HERUNTERGELADEN WERDEN: WWW.RG-RACING.COM

R&G

Unit 1, Shelley's Lane, East Worldham, Alton, Hampshire, GU34 3AQ

Tel: +44 (0)1420 89007 Fax: +44 (0)1420 87301 www.rg-racing.com Email: info@rg-racing.com



<u>SIE BENÖTIGEN FOLGENDES WERKZEUG</u>	<u>ALLGEM. ANZUGSDREHMOMENT</u>
<ul style="list-style-type: none"> • 8mm INBUSSCHLÜSSEL • 17mm STECKSCHLÜSSEL MIT EINEM 3/8" ODER 1/2" SCHRAUBENSCHLÜSSEL • DREHMOMENTSCHLÜSSEL BIS 40Nm. • PASSENDEN MOTORRADHEBER MIT WEICHEM STÜTZBEREICH (UM DEN MOTOR ZU STÜTZEN WÄHREND DER ENTFERNUNG DER MOTOR-SCHRAUBEN) 	<p>M4 SCHRAUBE = 8Nm M5 SCHRAUBE = 12Nm M6 SCHRAUBE = 15Nm M8 SCHRAUBE = 20Nm M10 SCHRAUBE = 40Nm M12 SCHRAUBE = 40Nm</p>

LIEFERUMFANG

ARTIKEL NR.	BESCHREIBUNG	MENGE
ARTIKEL 1	B0431 MIT CS341 (STURZPAD)	2
ARTIKEL 2	BC0002 (STURZPAD-KAPPE)	2
ARTIKEL 3	S1090 (DISTANZHALTER LINKS – 22mm LÄNGE x 10.5mm ID x 21mm OD)	1
ARTIKEL 4	S0798 (DISTANZHALTER RECHTS – 23mm LONG x 10.5mm ID x 22.5mm OD)	1
ARTIKEL 5	M10 x 1.25 x 110mm SECHSKANTSCHRAUBE (STURZPAD LINKE SEITE)	1
ARTIKEL 6	M10 x 1.25 x 120mm SECHSKANTSCHRAUBE (STURZPAD RECHTE SEITE)	1
ARTIKEL 7	M10 x 20mm OD UNTERLEGSCHIEBE	2
ARTIKEL 8	M12 EXT. ZAHNSCHIEBE	2

R&G

Unit 1, Shelley's Lane, East Worldham, Alton, Hampshire, GU34 3AQ

Tel: +44 (0)1420 89007 Fax: +44 (0)1420 87301 www.rg-racing.com Email: info@rg-racing.com



LINKE SEITE - ZEICHNUNG ZUSAMMENBAU

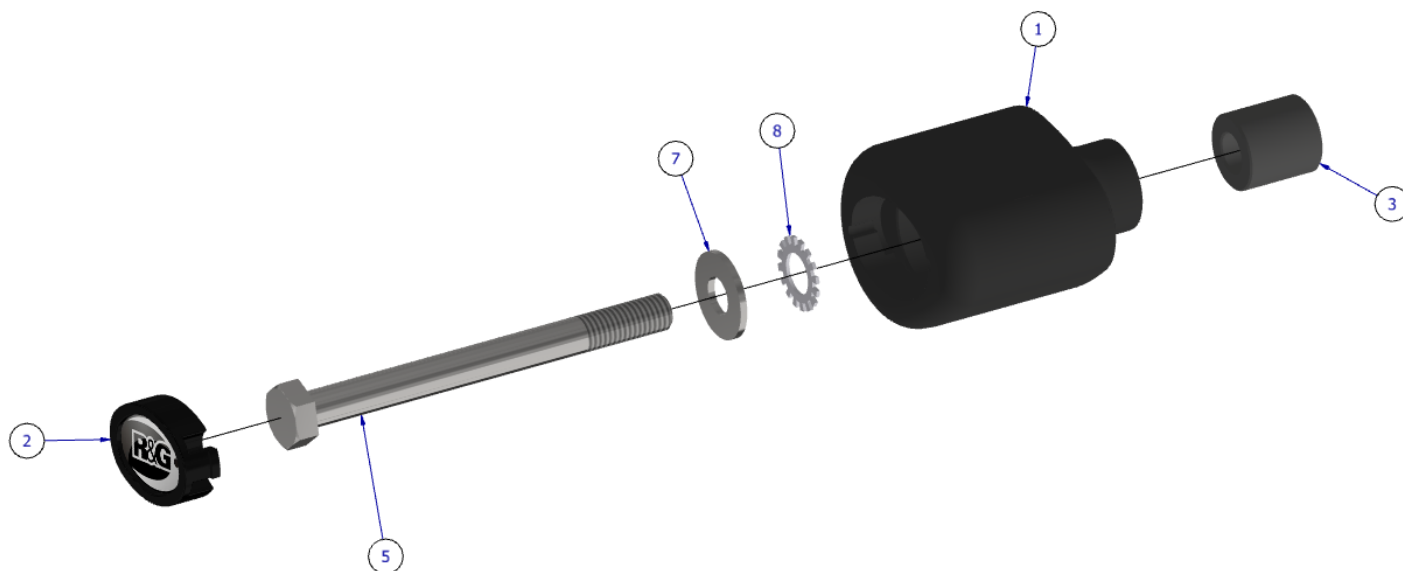

RECHTE SEITE - ZEICHNUNG ZUSAMMENBAU

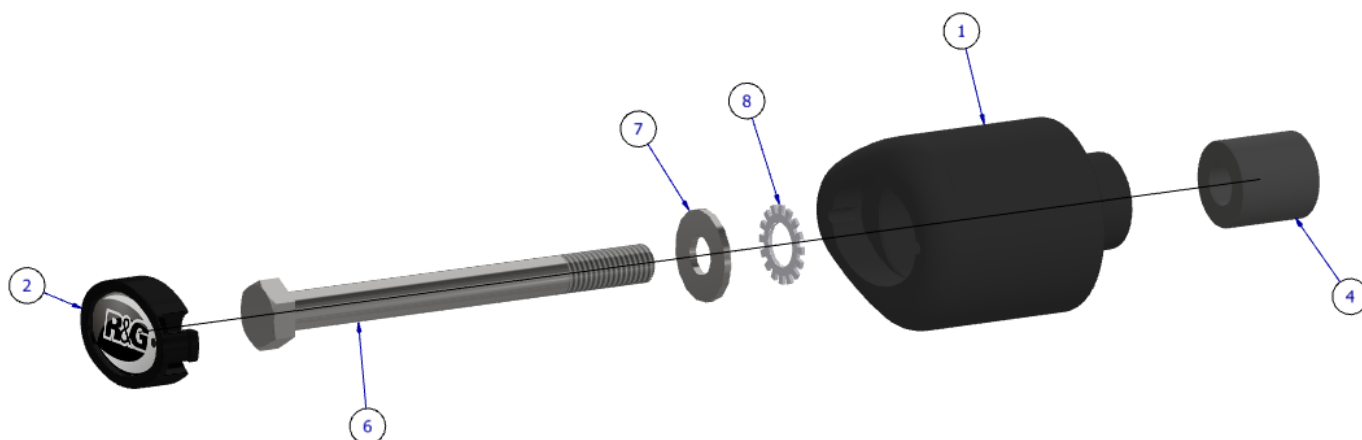

R&G

Unit 1, Shelley's Lane, East Worldham, Alton, Hampshire, GU34 3AQ

Tel: +44 (0)1420 89007 Fax: +44 (0)1420 87301 www.rg-racing.com Email: info@rg-racing.com



AERO-STURZPAD ORIENTIERUNG



MONTAGE - ABBILDUNGEN



Abbildung 1



Abbildung 2



MONTAGEANLEITUNG

HINWEIS: BEVOR SIE ANFANGEN, BENÖTIGEN SIE EINEN GEEIGNETEN HEBER, UM DEN MOTOR WÄHREND DER ENTFERNUNG DER SCHRAUBEN AM MOTOR ZU STÜTZEN. WENN SIE UNSICHER SIND, LASSEN SIE DAS KIT VON EINEM QUALIFIZIERTEN ZWEIRAD-MECHANIKER MONTIEREN. LESEN SIE DIE KOMPLETTE ANLEITUNG DURCH, BEVOR SIE MIT DER MONTAGE BEGINNEN.

- Einen passenden Motorradheber oder Montageständer mittig unter den Motor stellen und etwas Druck an der Unterseite des Motors anwenden **NICHT** am Auspuff oder am Rohr (bitte ein mittelweiches Material (Holz / Kunststoff usw.) als Puffer zwischen dem Stützbereich des Hebers und dem Motor benutzen, um es zu federn/das Gewicht zu verteilen und eventuelle Beschädigungen an der Unterseite des Motors zu verhindern).
- Bitte die Originalschraube an der linken Seite des Motors entfernen wie in **Abbildung 1** abgebildet.
- Die Einheit für die linke Seite zusammenbauen wie oben in der **ZEICHNUNG ZUSAMMENBAU- LINKE SEITE** abgebildet.
- Die Einheit für die linke Seite mit der M10 x 1.25 x 110mm Schraube vom Kit (**Artikel 5**) fixieren und mit dem oben angegebenen Anzugsdrehmoment befestigen.
- Bitte die Originalschraube an der rechten Seite des Motors entfernen wie in **Abbildung 2** abgebildet.
- Die Einheit für die rechte Seite zusammenbauen wie oben in der **ZEICHNUNG ZUSAMMENBAU- RECHTE SEITE** abgebildet.
- Die Einheit für die rechte Seite mit der M10 x 1.25 x 120mm Schraube vom Kit (**Artikel 6**) fixieren und mit dem oben angegebenen Anzugsdrehmoment befestigen.
- Anschließend bitte sicherstellen, dass alle Schrauben ordnungsgemäß mit dem richtigen Drehmoment festgezogen sind bevor Sie mit dem Motorrad fahren.

AUSGABE 1 - 27/05/2022 (AO)

CONSUMER NOTICE

The catalogue description and any exhibition of samples are only broad indications of the Products and R&G may make design changes which do not diminish their performance or visual appeal and supplying them in such state shall conform to the order. The Buyer acknowledges no representation or warranty (other than as to title) has been given or will apply to the Products other than those in R&G's order or confirmation and the Buyer confirms it has chosen the Products as being of merchantable quality and suitable for its particular purposes. Where R&G fits the Products or undertakes other services it shall exercise reasonable skill and care and rectify any fault free of charge unless the workmanship has been disturbed. The Buyer is responsible for ensuring that the warranty on the motorcycle is not affected by the fitting of the Products. On return of any defective Products R&G shall at its option either supply a replacement or refund the purchase money but shall not be liable if the Products have been modified or used or maintained otherwise than in accordance with R&G's or manufacturer's instructions and good engineering practice or if the defect arises from accident or neglect. Other than identified above and subject to R&G not limiting its liability for causing death and personal injury, it shall not be liable for indirect or consequential loss and otherwise its liability shall be limited to the amounts paid by the Buyer for the Products or the fitting or service concerned. These terms do not affect the Buyer's statutory rights.

R&G

Unit 1, Shelley's Lane, East Worldham, Alton, Hampshire, GU34 3AQ

Tel: +44 (0)1420 89007 Fax: +44 (0)1420 87301 www.rg-racing.com Email: info@rg-racing.com

**R&G RETURNS POLICY (NON-FAULTY GOODS)**

Returns must be pre-authorized (if not pre-authorized the return will be rejected). Goods may only be returned direct to us if they were purchased direct from us (customer must prove if necessary). Otherwise to be returned to original vendor. Goods must be in re-sellable condition, in the opinion of R&G. All returns are subject to a 25% restocking and handling fee (25% of the gross value exc. P&P – at the prevailing price at time of purchase). The customer must pay any and all carriage charges. No returns of discontinued products, unless within 14 days of purchase. This policy does not affect your statutory rights and does not refer to faulty goods.

R&G

Unit 1, Shelley's Lane, East Worldham, Alton, Hampshire, GU34 3AQ

Tel: +44 (0)1420 89007 Fax: +44 (0)1420 87301 www.rg-racing.com Email: info@rg-racing.com