



CP0498

FITTING INSTRUCTIONS FOR CP0498OR CRASH PROTECTORS
KTM 1290 SUPER DUKE R 2014-



PICTURE 1



PICTURE 2

THIS KIT CONTAINS THE ITEMS PICTURED AND LISTED BELOW.
DO NOT PROCEED UNTIL YOU ARE SURE ALL PARTS ARE PRESENT.

Please note that the way the kit is packed does not necessarily represent the way of mounting to the bike

THE PARTS SHOWN MAY BE REPRESENTATIVE ONLY (FOR CLARITY OF INSTRUCTIONS ONLY)

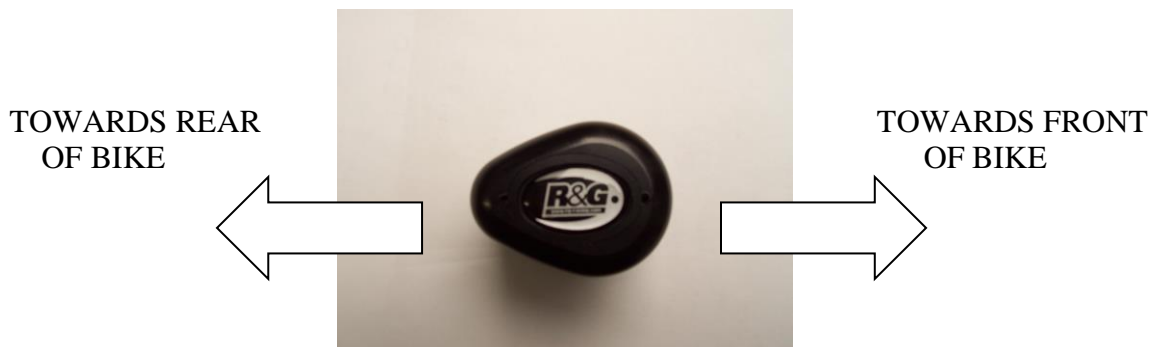

PICTURE 3



CP0498

LEFT HAND SIDE

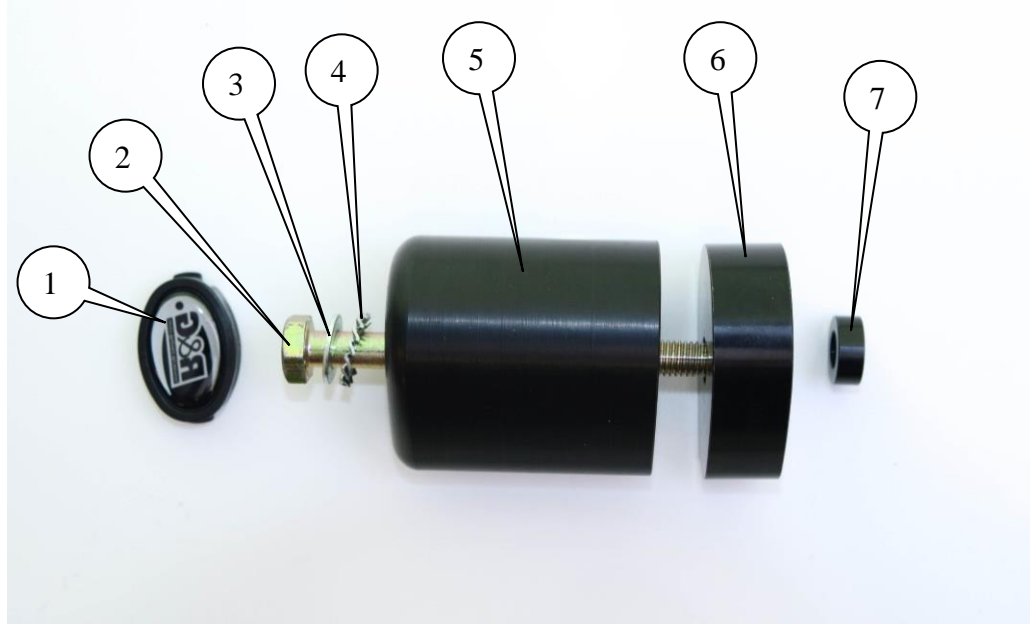

RIGHT HAND SIDE

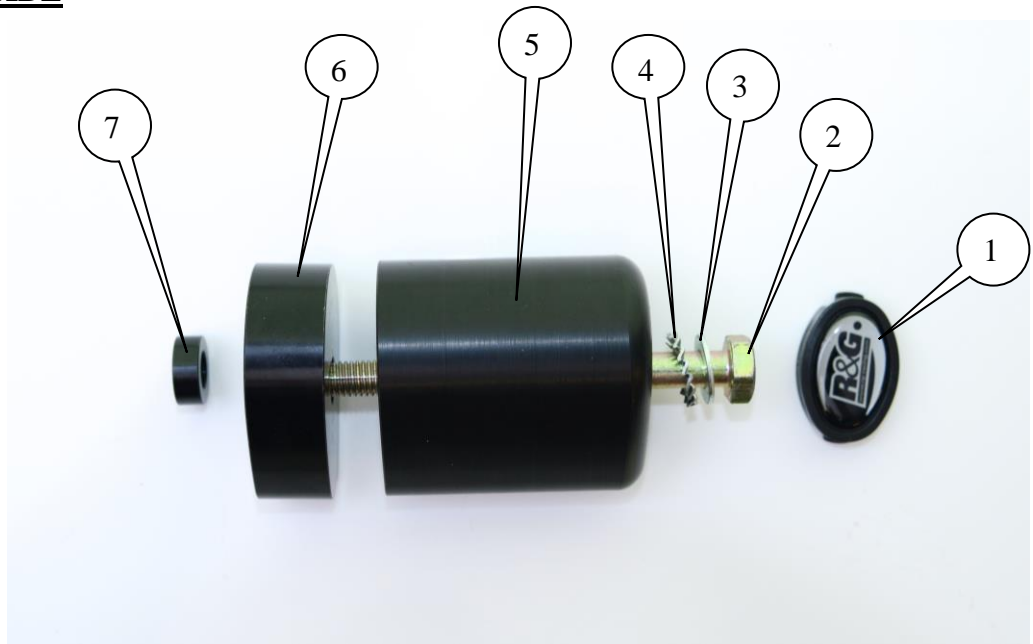



CP0498

LEGEND

ITEM 1 = BC0002 Bobbin Caps (x2).

ITEM 2 = M10 x 1.5 x 120mm LONG HEX HEAD BOLTS (CRASH PROTECTOR BOLTS) (x2).

ITEM 3 = M10 WASHERS (x2).

ITEM 4 = LW0001 (SHAKE PROOF WASHERS) (x2).

ITEM 5 = B0554 with CS341 (10mm) (BOTH CRASH PROTECTORS) (x2).

ITEM 6 = S1293 (SPACERS AERO SHAPED 20mm WIDE) (x2).

ITEM 7 = S0050 (SMALL SPACER 7mm WIDE) (x2).

Please note that in cases where kits are packed with rubber washers holding the components onto the bolt – *the rubber washers should be thrown away!*

TOOLS REQUIRED

- Socket set to include 17mm socket and wrench.
 - T45 Torx bit.
- Torque wrench (up to 40Nm).

Left-hand side (as you sit on bike)

- REMOVE THE ENGINE BOLTS IN POSITION SHOWN IN PICTURE 1.
- PLACE THE M10 PLAIN WASHER (ITEM 3) ONTO THE M10x120mm LONG HEX HEAD BOLT (ITEM 2), PLACE THE SHAKE PROOF WASHER (ITEM 4) ONTO THE BOLT UP TO PLAIN WASHER, PASS BOLT AND WASHERS THROUGH THE CRASH PROTECTOR (ITEM 5) SO WASHER GOES INTO RECESS.
- PLACE ONE OF THE AERO SPACERS (ITEM 6) OVER EXPOSED END OF BOLT AND UP TO THE CRASH PROTECTOR, PLACE ONE OF THE SMALL SPACERS (ITEM 7) OVER EXPOSED END OF BOLT AND UP TO THE CRASH PROTECTOR AS SHOWN ABOVE
- OFFER THE ASSEMBLY INTO THE MOUNTING HOLE AS SHOWN IN PICTURE 1. **PLEASE NOTE THE CRASH PROTECTOR (SLIDER) MUST BE POSITIONED AS SHOWN IN PICTURE 3 WITH BIGGER END TOWARD FRONT OF BIKE.** Tighten to 40Nm of torque (do not exceed this figure, as damage can occur to the motorcycle and the bolt).
- FIT CRASH PROTECTOR CAP (ITEM 1) TO THE CRASH PROTECTOR.

Right-hand side (as you sit on bike)

- REMOVE THE ENGINE BOLTS IN POSITION SHOWN IN PICTURE 2.
- PLACE THE M10 PLAIN WASHER (ITEM 3) ONTO THE M10x120mm LONG HEX HEAD BOLT (ITEM 2), PLACE THE SHAKE PROOF WASHER (ITEM 4) ONTO THE BOLT UP TO PLAIN WASHER, PASS BOLT AND WASHERS THROUGH THE CRASH PROTECTOR (ITEM 5) SO WASHER GOES INTO RECESS.
- PLACE ONE OF THE AERO SPACERS (ITEM 6) OVER EXPOSED END OF BOLT AND UP TO THE CRASH PROTECTOR, PLACE ONE OF THE SMALL SPACERS (ITEM 7) OVER EXPOSED END OF BOLT AND UP TO THE CRASH PROTECTOR AS SHOWN ABOVE
- OFFER THE ASSEMBLY INTO THE MOUNTING HOLE AS SHOWN IN PICTURE 2. **PLEASE NOTE THE CRASH PROTECTOR (SLIDER) MUST BE POSITIONED AS SHOWN IN**



CP0498

PICTURE 3 WITH BIGGER END TOWARD FRONT OF BIKE. Tighten to 40Nm of torque (do not exceed this figure, as damage can occur to the motorcycle and the bolt).

- FIT CRASH PROTECTOR CAP (ITEM 1) TO THE CRASH PROTECTOR.

GENERAL TORQUE SETTINGS

M4 BOLT = 8Nm
M5 BOLT = 12Nm
M6 BOLT = 15Nm
M8 BOLT = 20Nm
M10 BOLT = 40Nm

Issue 1 23/10/2020

CONSUMER NOTICE

The catalogue description and any exhibition of samples are only broad indications of the Products and R&G may make design changes which do not diminish their performance or visual appeal and supplying them in such state shall conform to the order. The Buyer acknowledges no representation or warranty (other than as to title) has been given or will apply to the Products other than those in R&G's order or confirmation and the Buyer confirms it has chosen the Products as being of merchantable quality and suitable for its particular purposes. Where R&G fits the Products or undertakes other services it shall exercise reasonable skill and care and rectify any fault free of charge unless the workmanship has been disturbed. The Buyer is responsible for ensuring that the warranty on the motorcycle is not affected by the fitting of the Products. On return of any defective Products R&G shall at its option either supply a replacement or refund the purchase money but shall not be liable if the Products have been modified or used or maintained otherwise than in accordance with R&G's or manufacturer's instructions and good engineering practice or if the defect arises from accident or neglect. Other than identified above and subject to R&G not limiting its liability for causing death and personal injury, it shall not be liable for indirect or consequential loss and otherwise its liability shall be limited to the amounts paid by the Buyer for the Products or the fitting or service concerned. These terms do not affect the Buyer's statutory rights.

R&G RACING RETURNS POLICY (NON-FAULTY GOODS)

Returns must be pre-authorized (if not pre-authorized the return will be rejected). Goods may only be returned direct to us if they were purchased direct from us (customer must prove if necessary). Otherwise to be returned to original vendor. Goods must be in re-sellable condition, in the opinion of R&G Racing. All returns are subject to a 25% restocking and handling fee (25% of the gross value exc. P&P – at the prevailing price at time of purchase). The customer must pay any and all carriage charges. No returns of discontinued products, unless within 14 days of purchase. This policy does not affect your statutory rights and does not refer to faulty goods.



CP0498

NOTICE DE MONTAGE POUR CP0498OR PROTECTIONS CRASH
KTM 1290 SUPER DUKE R 2014-



PHOTO 1



PHOTO 2

LE KIT CONTIENT LES ARTICLES EXPOSES CI-DESSOUS, VERIFIER QUE TOUTES LES PIECES SOIENT PRESENTES AVANT DE PROCEDER AU MONTAGE.

LA FAÇON DONT LE KIT EST EMBALLE NE CORRESPOND PAS FORCEMENT A LA FAÇON DE MONTER LES PIECES SUR LA MOTO.

LES PARTIES PRESENTEES PEUVENT ETRE UNIQUEMENT REPRESENTATIVES
(POUR LA CLARTE DES INSTRUCTIONS UNIQUEMENT)

ARRIERE MOTO



AVANT MOTO

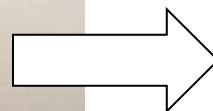
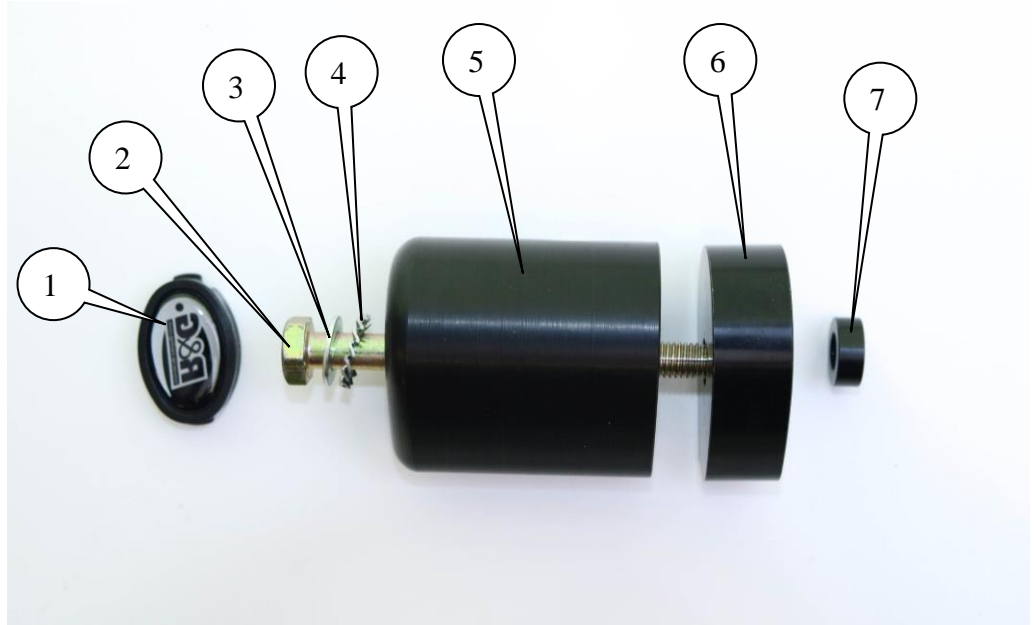

PHOTO 3



CP0498

COTÉ GAUCHE



COTÉ DROIT

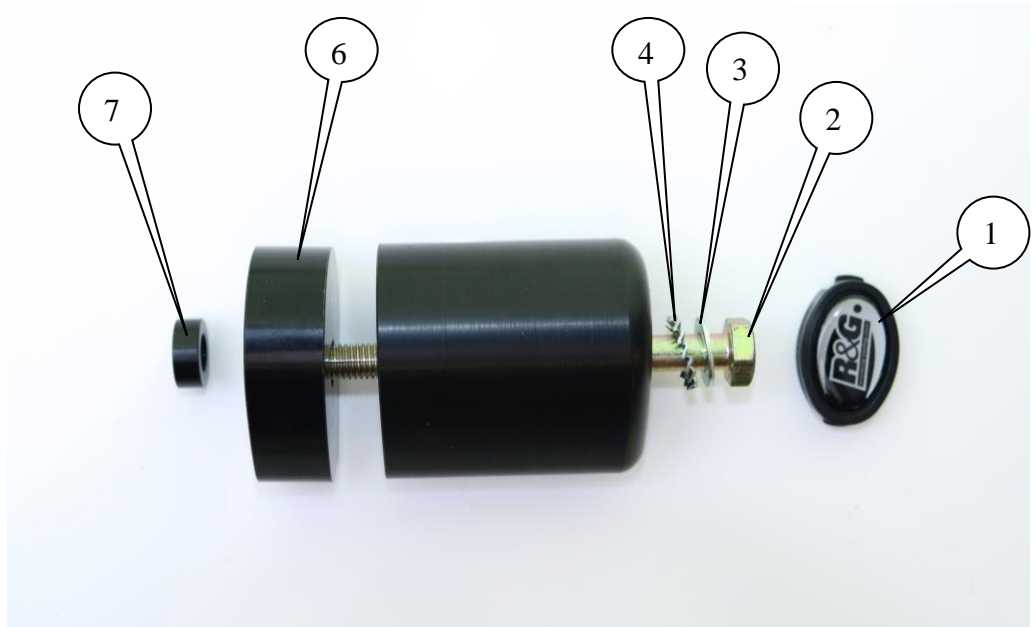



CP0498

LEGENDE

- ARTICLE 1 = BC0002 Capuchons de bobine (x2).
ARTICLE 2 = M10 x 1.5 x 120mm Boulons (x2).
ARTICLE 3 = M10 Rondelles (x2).
ARTICLE 4 = LW0001 (Rondelles anti vibration) (x2).
ARTICLE 5 = B0554 avec CS341 (10mm) (Les 2 protections crash) (x2).
ARTICLE 6 = S1293 (Entretoises 20mm de large) (x2).
ARTICLE 7 = S0050 (Petite entretoise 7mm de large) (x2).

Notez que si les kits sont emballés avec des rondelles en caoutchouc servant à tenir les composants, *ces rondelles doivent être jetées.*

OUTILS REQUIS

- Jeu de clés 17mm.
- Clé Torx T45.
- Clé dynamométrique (à 40Nm).

COTÉ GAUCHE (assis sur la moto)

- Enlever les boulons du moteur (Photo 1).
- Placer la rondelle M10 (Article 3) sur le boulon M10x120mm (Article 2), placer la rondelle anti vibration (Article 4) sur le boulon, au dessus de la rondelle. Passer le boulon et les rondelles à travers la protection crash (Article 5) pour que la rondelle aille dans le creux.
- Placer une des entretoises (Article 6) autour de l'extrémité du boulon et sur la protection crash, placer ensuite une des petites entretoises (Article 7) autour de l'extrémité du boulon et sur la protection crash comme indiqué ci dessus.
- Mettre l'ensemble en position à travers le trou de fixation (Photo 1). **LA PROTECTION (SLIDER) DOIT ETRE POSITIONNEE COMME SUR LA PHOTO 3 AVEC LE COTE ARRONDI LE PLUS GROS EN DIRECTION DE L'AVANT DE LA MOTO.** Serrer à 40Nm de couple (ne pas excéder cette valeur, car cela pourrait endommager la moto et le boulon).
- Mettre le capuchon de protection (ARTICLE 1) sur la Protection Crash.

COTÉ DROIT (assis sur la moto)

- Enlever les boulons du moteur (Photo 2).
- Placer la rondelle M10 (Article 3) sur le boulon M10x120mm (Article 2), placer la rondelle anti vibration (Article 4) sur le boulon, au dessus de la rondelle. Passer le boulon et les rondelles à travers la protection crash (Article 5) pour que la rondelle aille dans le creux.



CP0498

- Placer une des entretoises (Article 6) autour de l'extrémité du boulon et sur la protection crash, placer ensuite une des petites entretoises (Article 7) autour de l'extrémité du boulon et sur la protection crash comme indiqué ci dessus.
- Mettre l'ensemble en position à travers le trou de fixation (Photo 2). **LA PROTECTION (SLIDER) DOIT ETRE POSITIONNEE COMME SUR LA PHOTO 3 AVEC LE COTE ARRONDI LE PLUS GROS EN DIRECTION DE L'AVANT DE LA MOTO.** Serrer à 40Nm de couple (ne pas excéder cette valeur, car cela pourrait endommager la moto et le boulon).
- Mettre le capuchon de protection (Article 1) sur la Protection Crash.

COUPLES DE SERRAGE RECOMMANDES

M4 BOULON = 8Nm
M5 BOULON = 12Nm
M6 BOULON = 15Nm
M8 BOULON = 20Nm
M10 BOULON = 40Nm

Issue 1 23/10/2020